



# 2027 SUPER STAR



DYNAMIC. LUXURIOUS. POWERFUL.

# WHY SUPER STAR

The 2027 Super Star redefines what a Super Class C can be. With commanding front-engine visibility, a precision-engineered Freightliner® M-2 chassis, and industry-leading towing power, it's designed for travelers who demand capability without compromising comfort.

Inside, versatile living spaces shift effortlessly from open entertaining to private retreat. A residential-style kitchen, premium finishes, and smart design details elevate every mile. Trust the Super Star to put you confidently in command—on the road and at your destination.

## NEW FEATURES FOR 2027

- + Xite 360 Camera with Recording Functionality Now Standard
- + 30" Samsung® Stainless Steel Convection Microwave with Slim Fry Feature
- + Dovetail Cabinetry Drawers
- + Cab-Over Bunk with Skylight (Optional)
- + Starlink Internet System Now Standard (Subscription Required)
- + Pet Package: Includes Newmar-Branded Splash-Proof Food and Water Bowls and Exterior Leash Hook (Optional)



## FLOOR PLANS

5

+ Length 37-41'

## EXTERIORS

7

+ Onyx Package Available

## INTERIOR DÉCORS

3

## CUSTOMIZATIONS

- + **Customization Options Include:** paint colors, fabrics, flooring
- + **Kitchen and Bath Customizations:** backsplashes, sinks, plumbing fixtures, and cabinet hardware
- + **Electrical Customizations:** interior and exterior outlet placement and custom wiring runs based on preference

# WHY NEWMAR

Every Newmar coach is crafted with purpose, tailored to you, and backed by unwavering support. This relentless pursuit of excellence shapes everything we do. From the precision of our engineering to the responsiveness of our service. From the innovation in our designs to the personalization that honors our customer’s vision.

## PRODUCT FEATURES

### Residential Build

At Newmar, we craft every coach with the same proven techniques used in quality residential construction. Strong, layered sidewalls pair with precisely placed C-channel aluminum studs set 16 inches on-center, while a robust truss-built roof protects your investment for the long haul. Inside, premium flooring adds stability and comfort, and durable aluminum-framed windows are built to stand the test of time, coming together to deliver a coach made to last.

### Masterpiece Finish™

Every Newmar coach is finished with our Full-Paint Masterpiece Finish™, an industry-exclusive process crafted with premium BASF paints and applied entirely within our own 45,000-square-foot paint facility by skilled Newmar artisans. We were the first RV manufacturer to offer full-body paint across every model we build—a testament to our unwavering commitment to quality and our belief that your motorhome should be as beautiful on the outside as it is welcoming on the inside.



# NEWMAR SERVICE

At Newmar, we deliver a seamless service experience designed to get you back out on the road as soon as possible. It's all about providing you with an uncompromising service experience from the day you take delivery of your new home on wheels.

## SERVICE FEATURES

### Personal Service Tech

The Newmar Service Center offers personal service technicians and the ability to camp onsite with full hookups, receive in-depth education, use private workstations, visit with other Newmar owners in our lounge, and enjoy convenient laundry facilities along with dedicated pet lounges and a pet park.

### NewServ Mobile

With NewServ, our technicians come to you for routine maintenance. Services like appliance fixes, water pump maintenance, and more are available in Southern California, Arizona, and Central Florida. To schedule your appointment, call **800-731-8300**.

### Newgle for Product Knowledge

Explore Newgle—our free online knowledge base—packed with information straight from Newmar, as well as our component manufacturers and suppliers.

### Dedicated Brand Specialists

Newmar Service Account Managers, otherwise known as Brand Specialists, provide dealer warranty service authorizations within four business hours, and ship all in-stock parts the same day, via free ground shipment. And if a part is out of stock, they'll either pull it from the production floor or order the part from the appropriate supplier immediately.



# HARDWOOD CABINETRY OPTIONS

**SABLE** (SHOWN IN IMAGE)



## FEATURES

- + Maple Hardwood Cabinet Doors in Suede or High Gloss Finish
- + Available in Four Solid Colors and Three Two-Tone Finishes
- + Concealed Cabinet Door Hinges
- + Soft-Close Cabinet Drawers
- + Dovetail Cabinetry Drawers With Full Extension Ball Bearing Guides

## CABINET COLOR OPTIONS

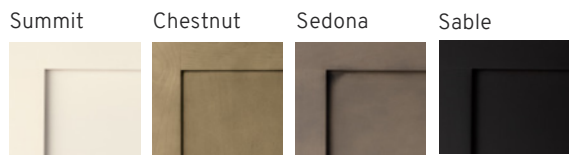

## TWO-TONE OPTIONS

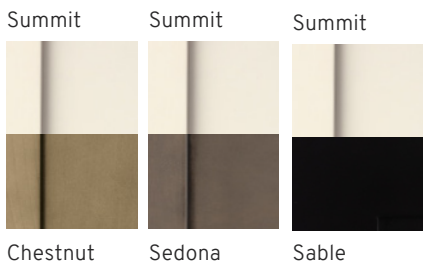

# INTERIOR DECOR OPTIONS

## NOLA (SHOWN IN IMAGES)



Leather Furniture & Ceiling Accent



Dinette Booth & Furniture Accent



Sofa Pillows



Bedspread & Bedroom Windows



Bed Pillow



Tile Flooring



Countertops

## SOLANO



Leather Furniture & Ceiling Accent



Dinette Booth & Cabin Windows



Sofa Pillows

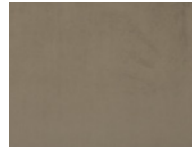

Bedspread & Bedroom Windows



Bed Pillow & Bed Scarf

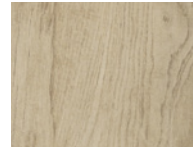

Tile Flooring



Countertop

## ASHFORD

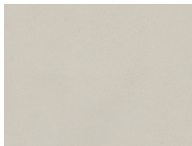

Leather Furniture & Ceiling Accent



Dinette Booth & Cabin Windows



Sofa Pillows

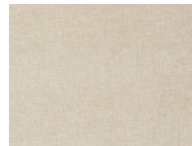

Bedspread & Bedroom Windows



Bed Pillow & Bed Scarf

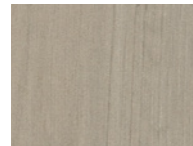

Tile Flooring

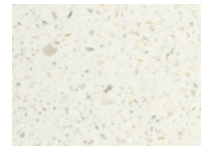

Countertop

Exterior color and interior décor options may be matched to customer preference, subject to availability. Please see your dealer for details.

# EXTERIOR DESIGN OPTIONS

## ARTIC SILK

Charcoal Tweed Awning



## DEEP SATIN

Charcoal Tweed Awning



## RUBY FLANNEL

Charcoal Tweed Awning



## VELVET SLATE

Charcoal Tweed Awning



## ALPINE

Charcoal Tweed Awning



## BLANCO

Charcoal Tweed Awning



## STEALTH

Charcoal Tweed Awning



### FEATURES

- + Industry-Exclusive Full-Paint Masterpiece Finish™ with Clearcoat and Cut and Buff
- + New Exterior Graphics and Colors with Seven Color Combinations\*

\*New for 2027

- + Ability to Customize Color Selections
- + Onyx Package Available (Optional)

Exterior color and interior décor options may be matched to customer preference, subject to availability. Please see your dealer for details.

# ONYX EXTERIOR PACKAGE

## KEY FEATURES

- + The Onyx Exterior Package replaces standard chrome accents with a sleek, blacked-out finish.
- + Exclusively available on the following coaches: King Aire, Essex, London Aire, Mountain Aire, New Aire, Dutch Star, Summit Aire, Supreme Aire, Super Star, Grand Star and Freedom Aire.
- + Not available on Bay Star, Bay Star Sport, Ventana, Northern Star and Canyon Star.
- + The Onyx Exterior Package is exclusively pre-order only and is not available aftermarket. To request a bold black-out style, see your Newmar dealer prior to purchase.

## The Onyx Package includes the following features:

- + Front Cap Accents
- + Rear Cap Accents
- + Entrance Grab Handle
- + Rock Guard
- + Wheels and Center Caps
- + Mirrors
- + Front and Back Logos
- + Baggage Door Trim\*

DUTCH STAR FEATURED IN IMAGES

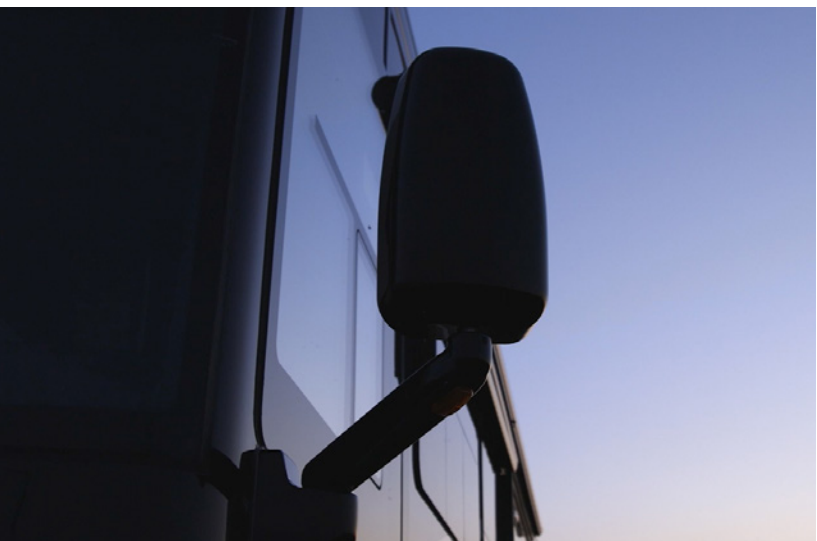

\*Baggage door trim is Standard on the King Aire, but optional for other eligible coaches.

# COCKPIT

## KEY FEATURES

- + Freightliner® M2 106 or M2 112 Chassis\*
- + Air Ride Driver and Passenger Seats with Pneumatic Lumbar, Swivel, Heat and Cooling
- + Cab-Over Bunk (Optional)
- + 10" Sony Dash Radio with Rear Coach Viewing, Apple CarPlay® and Android Auto
- + Detroit Assurance® 5.0 Lane Departure Warning System
- + Xite 360 Cameras with Recording\*\*

\*37' & 40' are M2 106; 41' is M2 112  
\*\*New for 2027



## POPULAR UPGRADE

- + SiriusXM® Radio Capability with Antenna (Subscription Required)

# CABIN

## KEY FEATURES

- + Multiple Seating Configurations Available
- + Samsung® 4K LED TV
- + Two 15K BTU Air Heat Pump Conditioners
- + Option to Replace Bunks with Desk and Chair to Create Dedicated Workspace (Floor Plans 4040 and 4140)
- + Cab-Over Bunk with Skylight (Optional)\*
- + Starlink Internet System (Subscription Required)
- + Pet Package: Includes Newmar-Branded Splash-Proof Water and Food Bowls and Exterior Leash Hook (Optional)\*

\*New for 2027



### POPULAR UPGRADE

- + Desk and Chair Replaces Midship Bunks to Create Workspace (Floor Plan 3940)

# GALLEY & DINETTE

## KEY FEATURES

- + Booth Dinette Sleeper Standard (Other Dinette Options Available)
- + 22 Cu. Ft. Samsung® Stainless Steel Smart French Door Refrigerator\*
- + 30" Samsung® Stainless Steel Convection Microwave with Slim Fry Feature\*
- + Dovetail Cabinetry Drawers\*
- + All-Electric Flush Mount Induction Cooktop
- + Dishwasher in a Drawer (Optional)
- + Pantry with Pull-Out Shelves

\*New for 2027



## POPULAR UPGRADES

- + Dishwasher in a Drawer
- + Euro Booth Dinette with Two Table Leaves, Removable Table Leg and Two Folding Chairs (Floor Plan Specific)

# BEDROOM

## KEY FEATURES

- + Floor Plans Featuring Both Queen or King-Size Beds with Plush Pillow Top Mattresses Available
- + Samsung® 4K LED TV
- + Lighted Wardrobe
- + Dimmable Reading Lights with Adjustable Arm
- + Spacious 30" x 72" Bunks Mid-Ship with Drawers Below (Floor Plans 4040 and 4140)
- + Option to Convert Bunks to Dedicated Working Space with Desk and Chair (Floor Plans 4040 and 4140)
- + Fitted Bedspread with Rounded Corners and Accent Pillows



## POPULAR UPGRADE

- + Air Mattress with Remote

# BATHROOM

## KEY FEATURES

- + 40" x 30" Shower with Skylight
- + Super Polished Solid-Surface Countertops
- + Linen Cabinet
- + Aqua Miser® Shower System



## POPULAR UPGRADES

- + Fold-Down Shower Seat
- + RV Sanicon Turbo System

# EXTERIOR FEATURES

## KEY FEATURES

- + Exterior Entertainment Center with 43" Samsung® 4K LED TV and Soundbar
- + Power Baggage Door Locks
- + Lighted Exterior Storage Compartments
- + Rear Cap Storage
- + Onyx Package Available (Optional)

*\*New for 2027*

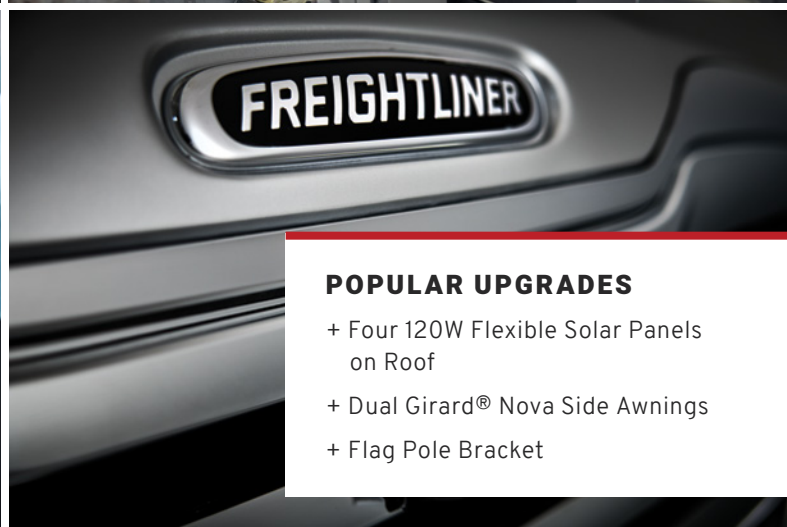

## POPULAR UPGRADES

- + Four 120W Flexible Solar Panels on Roof
- + Dual Girard® Nova Side Awnings
- + Flag Pole Bracket

# 3731 FLOOR PLAN

## STANDARD

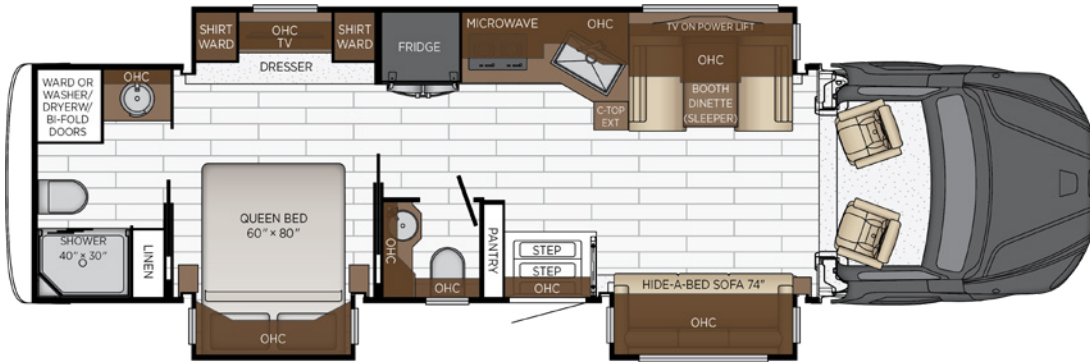

## OPTIONS

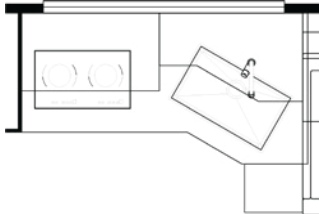
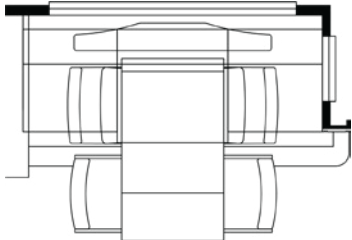
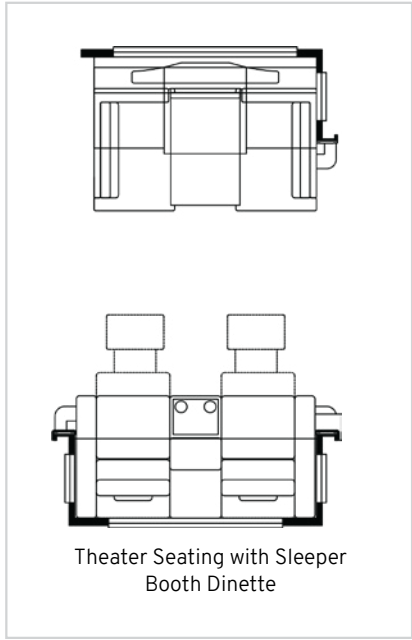

## PERFECT FOR

- + Those Desiring Maneuverability
- + National Park Enthusiasts, Stadium Tailgaters, or Those Visiting Space-Constrained Locations
- + Those Seeking Powerful Towing Capacity
- + Those Seeking Extra Storage and Hosting Flexibility with the New Cab-Over Bunk Option

Length	37' 11"	Interior Height	83"	Furnace	50,000 BTU
Width	101.5"	Grey Tank	60 gal.	Sleeps	2-5 People
App. Overall Height	13'	Sewage Tank	40 gal.		
Interior Width	95.5"	Water Tank	150 gal.		

# 4040 FLOOR PLAN

## STANDARD

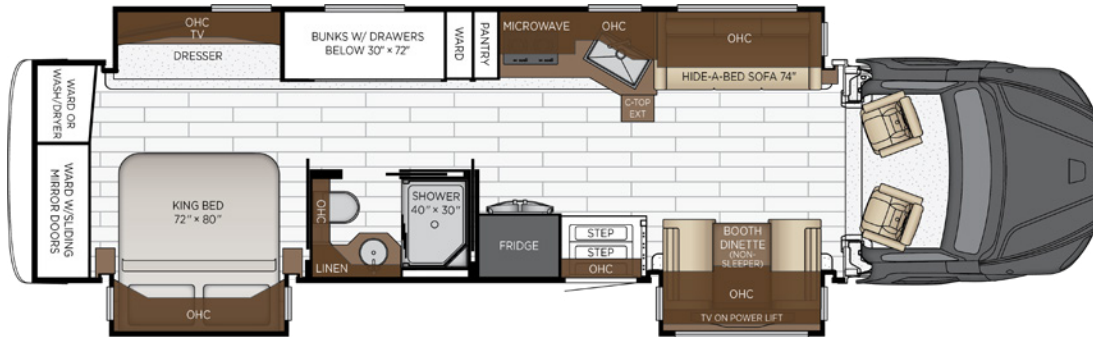

## OPTIONS

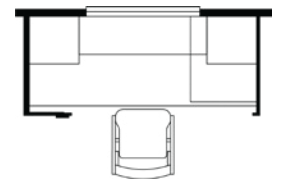
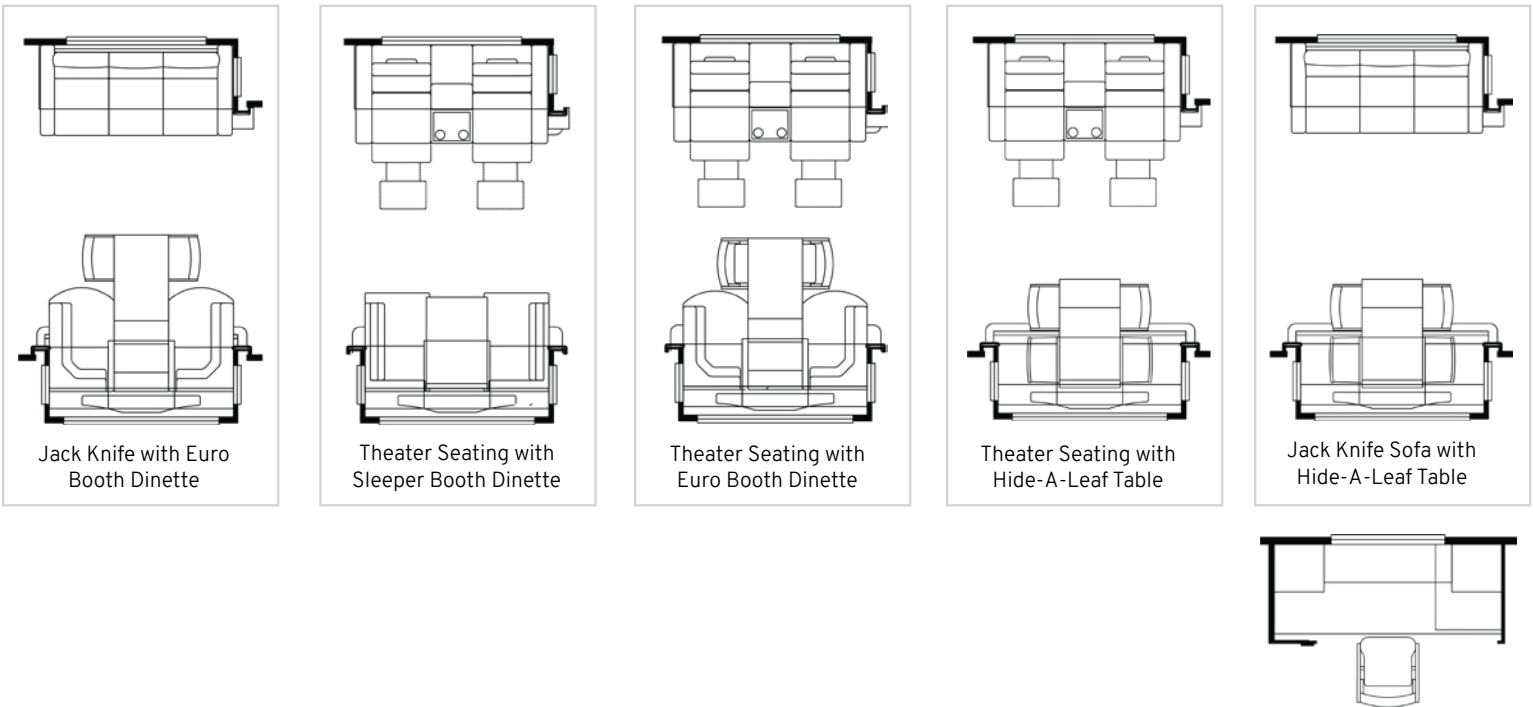

Desk Replaces Bunk

## PERFECT FOR

- + Families Seeking Comfort, Sophistication and Private Space
- + Those Desiring Dedicated Space to Work from The Road
- + Those Seeking Powerful Towing Capacity
- + Those Seeking Extra Storage and Hosting Flexibility with the New Cab-Over Bunk Option

Length	40' 11"	Interior Height	83"	Furnace	50,000 BTU
Width	101.5"	Grey Tank	60 gal.	Sleeps	2-6 People
App. Overall Height	13'	Sewage Tank	40 gal.		
Interior Width	95.5"	Water Tank	150 gal.		

# 4059 FLOOR PLAN

## STANDARD



## OPTIONS

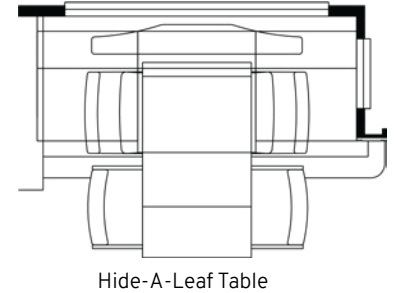
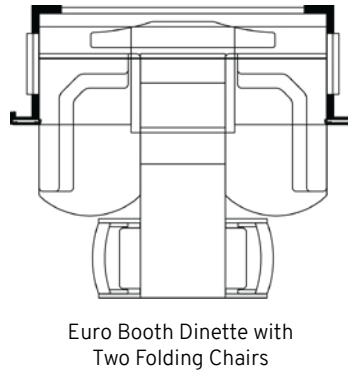
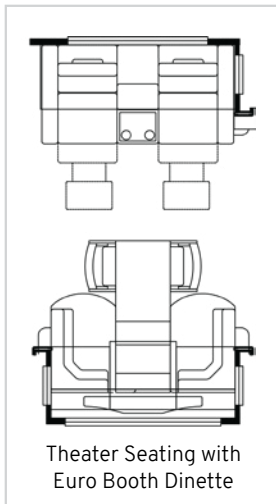
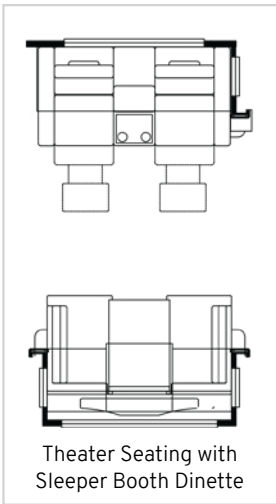

## PERFECT FOR

- + Couples Seeking Maximum Space and Private Retreats
- + Those Seeking Powerful Towing Capacity
- + Those Seeking Extra Storage and Hosting Flexibility with the New Cab-Over Bunk Option
- + Those Who Love Patio Views

Length	40' 11"	Interior Height	83"	Furnace	50,000 BTU
Width	101.5"	Grey Tank	60 gal.	Sleeps	2-5 People
App. Overall Height	13'	Sewage Tank	40 gal.		
Interior Width	95.5"	Water Tank	150 gal.		

# 4140 FLOOR PLAN

## STANDARD

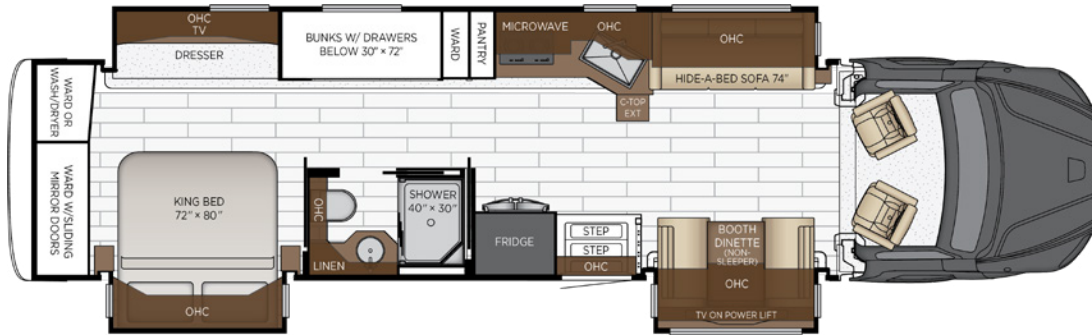

## OPTIONS

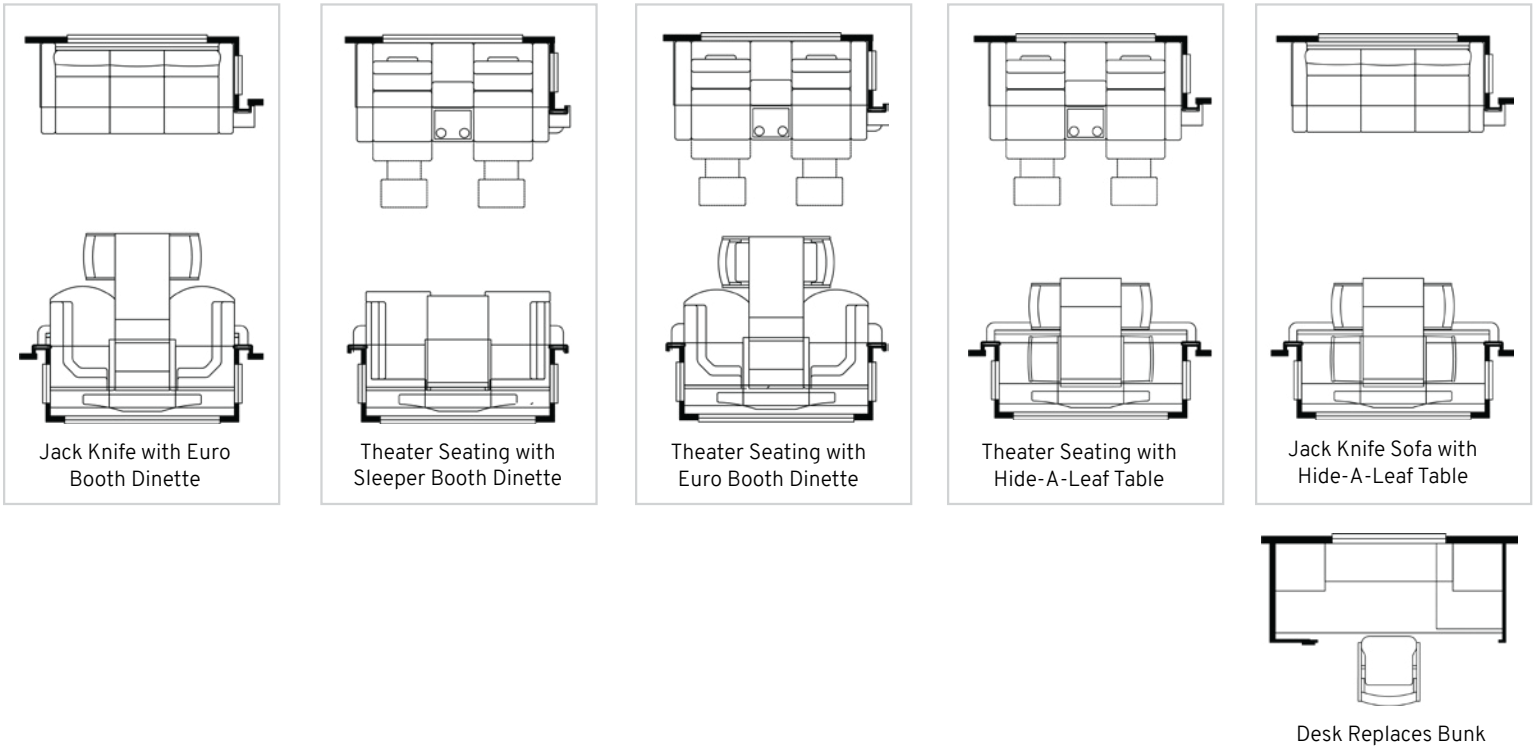

## PERFECT FOR

- + Families Seeking Comfort, Sophistication and Private Space
- + Those Desiring Dedicated Space to Work from the Road
- + Those Seeking Powerful Towing Capacity

Length	41' 11"	Interior Height	83"	Furnace	50,000 BTU
Width	101.5"	Grey Tank	60 gal.	Sleeps	2-6 People
App. Overall Height	13'	Sewage Tank	40 gal.		
Interior Width	95.5"	Water Tank	150 gal.		

# 4159 FLOOR PLAN

## STANDARD

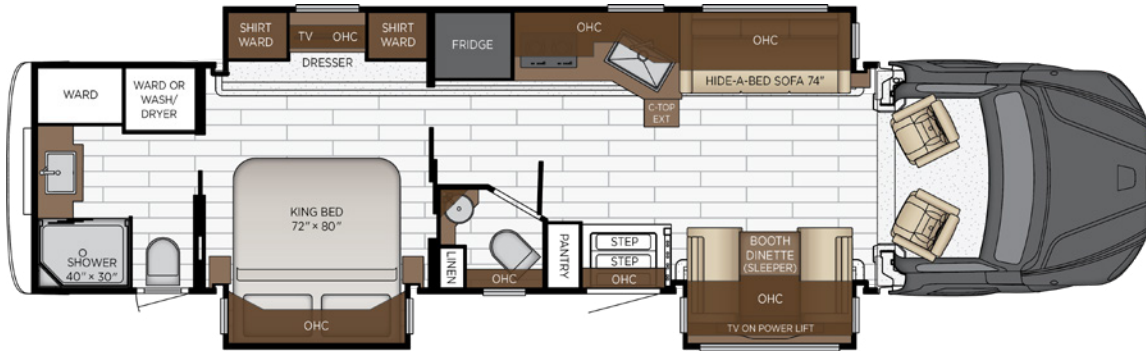

## OPTIONS

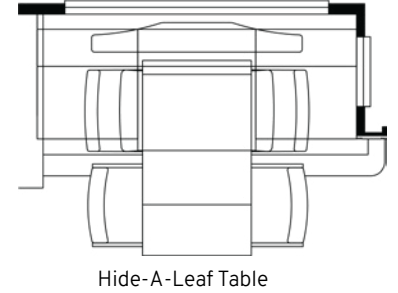
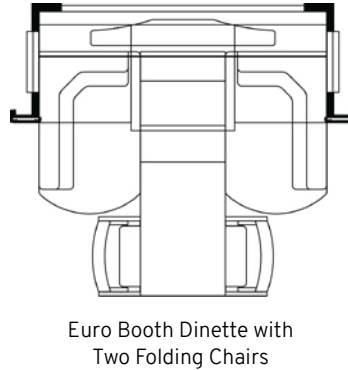
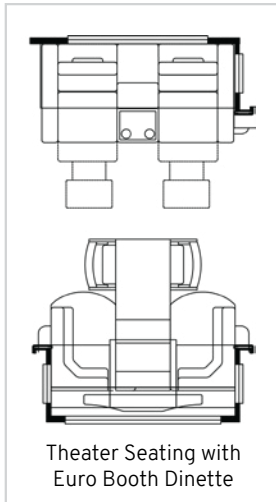
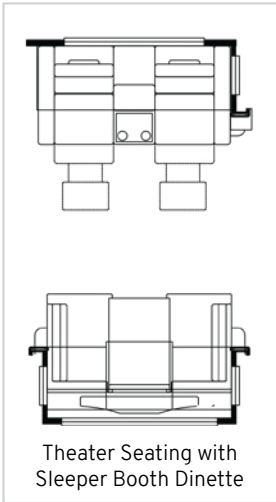

## PERFECT FOR

- + Couples Seeking Maximum Space and Private Retreats
- + Those Seeking Powerful Towing Capacity
- + Those Seeking Extra Storage and Hosting Flexibility with the New Cab-Over Bunk Option
- + Those Who Love Patio Views

Length	41' 08"	Interior Height	83"	Furnace	50,000 BTU
Width	101.5"	Grey Tank	60 gal.	Sleeps	2-5 People
App. Overall Height	13'	Sewage Tank	40 gal.		
Interior Width	95.5"	Water Tank	150 gal.		

# FLOOR PLAN SPECIFICATIONS

## FLOOR PLAN KEY FEATURES

### + 3731:

- **Perfect For:** Those Desiring Maneuverability, National Park Enthusiasts, Tailgaters, or Those Visiting Space-Constrained Locations, Those Seeking Powerful Towing Capacity, Those Seeking Extra Storage and Hosting Flexibility with the New Cab-Over Bunk Option
- **Key Features:** Maneuverability, King Bedroom Suite, Midship Bath with 40" x 30" Shower, Optional Cab-Over Bunk with Skylight

### + 4040:

- **Perfect For:** Families Seeking Comfort, Sophistication and Private Space, Those Desiring Dedicated Space to Work Home On the Road, Those Seeking Powerful Towing Capacity, Those Seeking Extra Storage and Hosting Flexibility with the New Cab-Over Bunk Option
- **Key Features:** King Bedroom Suite, Abundant Storage, Midship Bath with 40" x 30" Shower, Optional Cab-Over Bunk with Skylight, 20,000 lb. Towing Capacity, Optional Washer and Dryer

### + 4059:

- **Perfect For:** Couples Seeking Maximum Space and Private Retreats, Those Seeking Powerful Towing Capacity, Those Seeking Extra Storage and Hosting Flexibility with the New Cab-Over Bunk Option, Those Who Love Patio Views
- **Key Features:** King Bedroom Suite, Rear Spanning Ensuite Bathroom, Midship Bath with 40" x 30" Shower, Optional Cab-Over Bunk with Skylight, 20,000 lb. Towing Capacity, Optional Washer and Dryer

### + 4140:

- **Perfect For:** Families Seeking Comfort, Sophistication and Private Space, Those Desiring Dedicated Space to Work Home On the Road, Those Seeking Powerful Towing Capacity
- **Key Features:** King Bedroom Suite, Full Rear Bath Featuring a 40" x 30" Shower, Midship Half Bath, Optional Cab-Over Bunk with Skylight, 20,000 lb. Towing Capacity, Exceptional Stability When Parked

### + 4159:

- **Perfect For:** Couples Seeking Maximum Space and Private Retreats, Those Seeking Powerful Towing Capacity, Those Seeking Extra Storage and Hosting Flexibility with the New Cab-Over Bunk Option, Those Who Love Patio Views
- **Key Features:** Expansive Kitchen, Midship Half Bath, King Bedroom Suite, Full Rear Bath Featuring a 40" x 30" Shower, Optional Cab-Over Bunk with Skylight, 20,000 lb. Towing Capacity

FLOOR PLAN SPECIFICATIONS										
FLOOR PLAN	LENGTH	WIDTH	APP. OVERALL HEIGHT	INTERIOR WIDTH	INTERIOR HEIGHT	GREY TANK	SEWAGE TANK	WATER TANK	FURNACE	SLEEPS
3731	37' 11"	101.5"	13'	95.5"	83"	60 gal.	40 gal.	150 gal.	50,000 BTU	2-5
4040	40' 11"	101.5"	13'	95.5"	83"	60 gal.	40 gal.	150 gal.	50,000 BTU	2-6
4059	40' 11"	101.5"	13'	95.5"	83"	60 gal.	40 gal.	150 gal.	50,000 BTU	2-5
4140	41' 11"	101.5"	13'	95.5"	83"	60 gal.	40 gal.	150 gal.	50,000 BTU	2-6
4159	41' 11"	101.5"	13'	95.5"	83"	60 gal.	40 gal.	150 gal.	50,000 BTU	2-5

The content in our literature depicts and describes products that are subject to change. For the most recent images and information, please visit [NewmarCorp.com](http://NewmarCorp.com). Lengths, heights, widths, and dry weights are approximate. Weight will vary based on optional equipment added to the above base weight.

# CHASSIS



## CHASSIS

- + Freightliner® M2 106, 360 HP (37' and 40')
- + Freightliner® M2 112, 450 HP (41')

## HORSE POWER

360/450<sup>HP</sup>  
Cummins L9 Engine

### FUEL TANK

100<sub>GAL</sub>

### LENGTH

37-41<sub>FT</sub>

### TORQUE

1,150<sub>LB/FT</sub> (37' & 40')  
1,250<sub>LB/FT</sub> (41')

### AXLES

2

### TIRE SIZE

22.5"

Michelin Brand  
Front: 315/80R 20-ply  
Rear: 295/80R 16-ply

### STEERING WHEEL

Manual Tilt/Telescope  
Steering Wheel

### SAFETY

- + Detroit Assurance® Safety Systems  
Auto On/Off Headlights, Intelligent High Beams, Auto Rain Sense Wipers
- + Detroit Assurance® Safety Systems  
Object Detection, Active Brake Assist, Pedestrian Detection

### TRANSMISSION

Allison 3200 TRV 6-Speed  
Automatic

# CHASSIS SPECIFICATIONS

## GLOSSARY

- + **GAWR:** Gross Axle Weight Rating is the maximum permissible weight for an axle.
- + **GVWR:** Gross Vehicle Weight Rating is the maximum permissible weight for a fully loaded motor coach.
- + **GCWR:** Gross Combination Weight Rating is the value specified by the manufacturer of the vehicle as the maximum allowable loaded weight of this motor coach and any towed trailer or towed vehicle.
- + **UVW:** Unloaded Vehicle Weight is the weight of this motor coach as built at the factory with full fuel, engine oil, and coolants. Does not include cargo, fresh water, propane gas, or dealer-installed accessories.
- + **NCC:** Net Carrying Capacity is the maximum weight of all occupants, including the driver, personal belongings, food, fresh water, waste water, propane gas, tools, tongue weight of towed vehicle, dealer-installed accessories, etc., that can be carried by the motor coach.
- + Specifications supplied by the chassis manufacturer.

FREIGHTLINER® CUSTOM CHASSIS												
FLOOR PLAN	ENGINE HP	AXLE RATIO	FUEL CAP.	WHEEL BASE	TIRE SIZE	FRONT GAWR	REAR GAWR	TAG GAWR	GVWR	GCWR	APP. UVW	APP. NCC
3731	360	4.89	100	320	22.5"	16000 lb.	24000 lb.	0	40000 lb.	60000 lb.	33500 lb.	6500 lb.
4040	360	4.89	100	345	22.5"	17200 lb.	24000 lb.	0	41200 lb.	60000 lb.	34500 lb.	6700 lb.
4059	360	4.89	100	345	22.5"	17200 lb.	24000 lb.	0	41200 lb.	60000 lb.	34500 lb.	6700 lb.
4140	450	3.91	100	345	22.5"	18000 lb.	25000 lb.	0	43000 lb.	60000 lb.	34500 lb.	8500 lb.
4159	450	3.91	100	345	22.5"	18000 lb.	25000 lb.	0	43000 lb.	64000 lb.	34500 lb.	8500 lb.

The content in our literature depicts and describes products that are subject to change. For the most recent images and information, please visit [NewmarCorp.com](http://NewmarCorp.com). Lengths, heights, widths, and dry weights are approximate. Weight will vary based on optional equipment added to the above base weight.

# STANDARD FEATURES & OPTIONS

## EXTERIOR FEATURES

- Full-Paint Masterpiece Finish™ with Clearcoat and Cut and Buff
- Painted Power Baggage Door Locks, Keyless Entrance Door with Touchpad and Door Bell
- Entrance Door Assist Handle
- Automatic Entrance Door Step
- Chrome Exterior Mirrors
- Power Convex Exterior Mirrors with Defrost
- Front Cap Diamond Shield Protection
- Hydraulic Leveling Jacks
- Mud Flaps
- Power Lock on Cockpit Doors
- Rear Cap Storage
- Rear Protective Tow Guard with Stainless Newmar Letters
- Undercoating

## OPTIONS

- Power Chrome Baggage Door Locks
- Flag Pole Bracket
- Non-Powered Storage Trays (Size and Placement are Floor Plan Specific)

## CONSTRUCTION FEATURES

- 16" On-Center Aluminum Frame Sidewalls and Roof Construction
- Egress Door with Ladder System (Floor Plan Specific)
- Fiberglass Roof and Integrated Gutter Rail
- Foam Insulation 5/8" Laminated in Sidewalls and Ceiling
- Gelcoated Fiberglass Exterior Sidewalls, Front and Rear Caps
- Polar Pak R19 Batten Insulation in Roof
- Slideout Automatic Mechanical Lock Arms - Scissor Style
- Slideout Rack and Pinion Flat Floor

## WINDOWS, AWNINGS, & VENTS

- Bunk Windows (Floor Plan Specific)
- Carefree® Slideout Covers
- Fan-Tastic® Vent with Rain Sensor in Kitchen and Bathroom
- Girard® G2000 Integrated Side Awning
- Sky Window in Cockpit with Power Shade
- Skylight Above Shower
- Power Window for Driver and Passenger
- Frameless Double-Pane Tinted Safety-Glass Windows

## OPTIONS

- Dual Girard® Nova Side Awnings
- Kitchen Window (Floor Plan Specific)

## CHASSIS FEATURES

- Allison 6-Speed 3200 TRV Transmission
- Anti-Lock Braking System

Battery Disconnect for Chassis Battery

Cruise Control

Detroit Assurance® Safety Systems Auto On/Off Headlights, Intelligent High Beams, Auto Rain Sense Wipers

Detroit Assurance® Safety Systems Object Detection, Active Brake Assist, Pedestrian Detection

100 Gallon Fuel Capacity Total, Dual 50 Gallon Tanks

20K Rear Hitch for Towing with 2" Reducer and Drawbar with 2" and 2-5/16" Ball

Remote Keyless Entry System for Cab Doors

Freightliner® M2 106 Chassis, Cummins® 360 L Engine, 320" Wheel Base, 24000# Single Rear Axle

Freightliner® M2 106 Chassis, Cummins® 360 L Engine, 345" Wheel Base, 24000# Single Rear Axle

Freightliner® M2 112 Chassis, Cummins® 450 L Engine, 345" Wheel Base, 24000# Single Rear Axle

Manual Tilt/Telescope Steering Wheel

Aluminum Wheels

## OPTIONS

- Freightliner® M2 106 Chassis, Cummins® 360 L Engine, 320" Wheel Base, 24000# Single Rear Axle, Onyx Package
- Freightliner® M2 106 Chassis, Cummins® 360 L Engine, 345" Wheel Base, 24000# Single Rear Axle, Onyx Package
- Freightliner® M2 112 Chassis, Cummins® 450 L Engine, 345" Wheel Base, 24000# Single Rear Axle, Onyx Package

## AIR CONDITIONING & HEATING

- Two 15K BTU Air Heat Pump Conditioners
- Air Conditioning Drainage System for Roof
- Chinook Dual Loop Heat with Continuous Hot Water
- Dash Heater and Air Conditioner
- Wall Mounted Sensors for Heating and Air Conditioning
- Wall Mounted Sensors for Heating and Air Conditioning

## OPTIONS

- Electric Radiant Heat Installed Below Floor Tile

## ELECTRICAL FEATURES

- Automatic Generator Start on Low Battery or Temperature Setting
- Battery Disconnect Switch for House Battery
- Cable TV Connection
- 50 Amp Electrical Service with Flexible Cord and Automatic Transfer Switch
- Energy Management System
- Engine Block Heater
- Exterior Security Light, One Installed on Door Side
- Eight 6V AGM House Batteries
- Interior Courtesy Lights
- 3000W Pure Sine Inverter

# STANDARD FEATURES & OPTIONS (CONTINUED)

Recessed LED Lights in Ceiling and Underneath Overhead Cabinets
Lights in Exterior Storage Compartments
Lights in Wardrobes
Multiplex Lighting Control System
10.1" Multiplex Monitor System in Center of Coach with Interior Lighting and HVAC Controls
Newmar App
8.0 kW Cummins Onan® Diesel Quiet Series Generator
Power Rewind Reel with 50' Cord
Dimmable Reading Lights at Head of Bed Feature Adjustable Arm
110V Recept in Bed Overhead with Two Pass Through Ports
110V/USB Recept at Head of Each Bunk Area (Floor Plan Specific)
12V Recept Auxiliary on Dashboard
Slideout Switch Manually Operated Hold to Run
10W Solar Panel to Charge Chassis Battery
Spare Fuses in Chassis Fuse Panel
Spare Fuses in House Fuse Panel
Transfer Switch with Surge Protector
USB Outlet at Dinette and Bedroom Night Stand

## OPTIONS

- 30 Amp/120V Cord Connection for Stacker Trailer
- Exterior Security Lights, Two Door Side, Two Off-Door Side, One Rear Replaces Standard
- 640 AHR Lithionics® Lithium Ion Battery System with Two 3000W Pure Sine Inverters (UL Approved)
- Four 120W Flexible Solar Panels on Roof
- Solar Prep with 6 Gauge Wire Ran from Roof to House Battery Compartment

## PLUMBING & BATH FEATURES

Aqua Miser® Shower System
Auto Fill in Water Works Compartment
Demand Water System
12V Dump Valves
Exterior Shower Located on Off-Door Side
150 Gallon Fresh Water Tank
Power Reel for Water Hose
Sewage Holding Tank Rinse
Fiberglass Surround Shower with Shower Door
Dometic® 321 China Bowl or Macerator China Bowl Stool (Varies per Floor Plan)
Water Filter for Entire Unit

## OPTIONS

- Fold-Down Shower Seat
- Hot Water Line Run to Front Door-Side Storage Bay
- RV Sanicon Turbo System

## INTERIOR FEATURES

Fitted Bedspread and Accent Pillows
Decorative Wall Art
Interior Passage Inlayed Three Panel Design Doors
Interior Assist Handle at Main Entry Door
Window Shades
Padded Vinyl Ceiling Panels with Designer Feature
Power Stepwell Cover
Removable Transport Pads for Under Slideout Rollers
Hardwood Slideout Fascia
Tile Floor in Kitchen, Bathroom, Bedroom and Living Areas
Wastebasket in Kitchen Base Under Sink
Woven Material on Slideout Floors
Shoe Storage Located In Entrance Door Step Compartment

## OPTIONS

- Pet Package: Includes Newmar-Branded Splash-Proof Water and Food Bowls and Exterior Leash Hook

## CABINETS & FURNITURE

Concealed Cabinet Door Hinges
Soft-Close Cabinet Drawers
Dovetail Cabinetry Drawers
Mesh Cell Phone Holder at Each Bunk Bed (Floor Plan Specific)
Flush Cooktop Cover, Matching Countertop Material
Super Polished Solid-Surface Countertop in Bathroom and Bedroom
Super Polished Solid-Surface Countertop in Kitchen, Undermount Sink and Sink Covers
Sleeper Booth Dinette
Air Ride Driver and Passenger Seats with Pneumatic Lumbar, Swivel, Heat and Cooling
Ultrafabric Sofa
Lifts on Bed Top
Plush Pillow Top Mattress
Silverware Divider Tray
Pullout Pantry Shelves (See Floor Plans for Availability)
Villa Comfort Fit Furniture

## OPTIONS

- Convertible Dinette with Two Fixed and Two Folding Chairs
- Buffet Dinette with Free Standing Table, Two Fixed and Two Folding Chairs
- Euro Booth Dinette with Two Table Leaves, Removable Table Leg and Two Folding Chairs
- Hide-A-Leaf Table Dinette with Two Fixed and Two Folding Chairs Replaces Booth Dinette
- Air Mattress with Remote
- Two Recliners with Reading Lights and Lampstand Replaces 87" Side Hide-A-Bed Sofa on Off-Door Side (Replaces Only Sofa)

# STANDARD FEATURES & OPTIONS (CONTINUED)

- 74" Jackknife Sofa Replaces Hide-A-Bed Sofa on Off-Door Side, Euro Booth Dinette on Door Side
- 74" Jackknife Sofa Replaces Hide-A-Bed Sofa on Off-Door Side, Hide-A-Leaf Table Dinette with Two Folding and Two Fixed Chairs on Door Side
- 74" Powered Theater Seating with Adjustable Headrests and Reading Lights on Off-Door Side, 38" Euro Booth Dinette on Door Side
- 74" Powered Theater Seating with Adjustable Headrests and Reading Lights on Off-Door Side, 38" Sleeper Booth Dinette on Door Side
- 74" Powered Theater Seating with Adjustable Headrests on Off-Door Side, Hide-A-Leaf Table Dinette with Two Folding and Two Fixed Chairs on Door Side
- 87" Powered Theater Seating with Adjustable Headrests and Reading Lights Replaces Side Hide-A-Bed Sofa on Off-Door Side
- Bunk-Over Cab with Ladder
- Desk and Chair Replaces Midship Bunks to Create Workspace

## APPLIANCES & ACCESSORIES

- Air Horns
- All-Electric Flush Mount Induction Cooktop
- 110V Heat Pads for Holding Tanks
- 30" Samsung® Stainless Steel Convection Microwave with Slim Fry Feature
- 22 Cu. Ft. Samsung® Stainless Steel Smart French Door Refrigerator
- Washer and Dryer Prep

## OPTIONS

- Central Vacuum with Tool Kit
- Dishwasher in a Drawer with Stainless Steel Front Located Below Cooktop
- Freezer on Pullout Tray in Exterior Compartment
- Stacked Two-Piece Splendide® Washer and Dryer

## AUDIO, VIDEO & ACCESSORIES

- Side View Cameras Displayed onto Radio Monitor Screen
- Cat6 TV Cables
- CB Prep with Antenna
- Exterior Entertainment Center with 43" Samsung® 4K LED TV and Soundbar
- 10 BC Fire Extinguisher, Carbon Monoxide, Smoke Detectors
- 180W Harman/JBL Sound System and Subwoofer
- High Definition Component Wiring
- Bluetooth Microphone for Dash Radio
- Rear View Color Monitor System with Audio
- Satellite Dish Prep on Roof
- 10" Sony Dash Radio with Rear Coach Viewing, Apple CarPlay® and Android Auto™
- Bose® Sound System Soundbar
- TV Jack and 110V Recept in Door-Side Exterior Storage Compartment
- Samsung® 4K LED TV in Living and Bedroom Areas (TV Sizes Vary per Floor Plan)
- 50" Samsung® 4K LED TV on Televator in Living Area (Select Floor Plans)
- Starlink Internet System with Mobility Mount (Subscription Required)

## OPTIONS

- SiriusXM® Radio Capability with Antenna (Subscription Required)
- Satellite Prep Ground Tripod Dish on Off-Door Side with A/B Switch
- Two 22" Connexx TV/DVD Monitors - One at Each Standard Bunk (Floor Plan Specific)
- WiFi System Everest w/Aspen Interior Router
- Winegard® Rayzar Automatic Digital TV Antenna
- Xite HD 360 Camera System with Grid Lines and Tri-View Rear Camera with Xite Radio

# OUR PARTNERS

## THE NEWMAR DIFFERENCE™

The Newmar Difference™ begins with suppliers dedicated to providing our customers with unrivaled quality, comfort, and support. We only work with suppliers that are dedicated to providing our customers with unrivaled innovation, comfort, and reliability. It's all so you can experience best-in-class performance from names you can trust. At Newmar, that's our difference, and our promise.



### BASF

The Coatings division of BASF is a global expert in the development and production of innovative and sustainable OEM and refinish coatings. Coatings by BASF—solutions beyond your imagination.



### Freightliner® Custom Chassis

Freightliner® Custom Chassis are renowned for their exceptional ride, excellent maneuverability, advanced technology, and nationwide 24/7 factory-direct support.



### Spartan® RV Chassis

An American company with over 40 years of experience in designing and manufacturing the premier motorhome chassis, Spartan® delivers superior performance, exceptional safety ratings, and industry-leading technology.



### Industrial Finishes

Industrial Finishes has supported RV manufacturers for over four decades, offering paint products that deliver uncompromising quality and provide your coach with a true Masterpiece™ finish.



### RiverPark

From Samsung® 4K TVs and Xite Infotainment systems to Bose® soundbars and JBL and Infinity premium audio systems, RiverPark helps ensure you enjoy the ultimate audio-visual technology in your Newmar coach.

# THE NEWMAR CUSTOMER EXPERIENCE

The Newmar Difference™ goes beyond our industry-leading motor coaches to provide you with an unrivaled ownership experience.



## Crafted with Purpose

Every Newmar is crafted one at a time by folks who have spent an average of eight years building them. Each coach we assemble must undergo more than 1,000 tests and checks before ever leaving our factory.



## The Highest Standards

We view our dealership network in terms of quality, not quantity. Each of our dealers acts as a partner in our shared mission to exceed your highest of expectations, for an ownership experience that's second to none from day one.



## Built Around You

As a Newmar owner, you'll find resources specific to your coach through Newgle, an easy-to-use knowledge base that houses everything from user guides to technical support documents.



## More Than a Number

Meet fellow owners through the Newmar Kountry Klub, a top social club for RV travelers that hosts rallies and other special events throughout the U.S. and Canada.



## Seamless Service

When you join the Newmar family, we pair you with a dedicated service specialist with expert knowledge of your exact coach. Our service specialists guarantee dealer warranty authorizations within four business hours and ship all in-stock parts the same day, free of charge.



## Without Compromise

All models include a one-year/unlimited mileage limited warranty and a five-year, non-transferable structural warranty that covers your coach's superstructure in the event it fails to perform. Ask your Newmar dealer for more details.

## CONTACT

Newmar Corporation  
1952 Cheyenne St.  
Nappanee, IN 46550

+ Phone: 574-773-7791  
+ Fax: 574-773-2895  
+ NewmarCorp.com

