



2027 BAY STAR



DYNAMIC. SPACIOUS. RELIABLE.

WHY BAY STAR

Experience a balance of attainable refinement and dependable quality as you step into Class A living with this accessible gas coach. Designed to support every moment of your journey, the Bay Star blends handcrafted construction with thoughtful design that elevates life on the road. Whether you're sharing family dinners with a beautiful view or enjoying evenings outdoors under the stars, this coach gives you the freedom to travel exactly as you imagine.

NEW FEATURES FOR 2027

- + Built-In Power for Your Dash Camera
- + Dovetail Cabinetry Drawers Now Standard
- + Updated Window Treatments and Valances
- + Choice of Spacious Bunks or Private Workspace on New Floor Plan 3640
- + Starlink Internet System Now Standard (Subscription Required)
- + Pet Package: Includes Newmar-Branded Splash-Proof Water and Food Bowls, Exterior Leash Hook and Retractable Pet Gate (Optional)



FLOOR PLANS

7

- + Length Ranges from 31'-38'
- + Bunk Floor Plan Available
- + Wheelchair-Accessible Floor Plan Available

EXTERIORS

3

INTERIOR DÉCORS

3

CUSTOMIZATIONS

- + Customization Options Include: paint colors, fabrics, flooring
- + Kitchen and Bath Customizations: backsplashes, sinks, plumbing fixtures, and cabinet hardware
- + Electrical Customizations: interior and exterior outlet placement and custom wiring runs based on preference

WHY NEWMAR

Every Newmar coach is crafted with purpose, tailored to you, and backed by unwavering support. This relentless pursuit of excellence shapes everything we do. From the precision of our engineering to the responsiveness of our service. From the innovation in our designs to the personalization that honors our customer’s vision.

PRODUCT FEATURES

STAR Foundation

Your foundation for confidence begins with stability. The exclusive STAR Foundation delivers both strength and serenity through its precisely engineered steel superstructure. Carefully welded to every luxury chassis, you'll experience a ride that's both quiet and more stable.

Residential Build

At Newmar, we craft every coach with the same proven techniques used in quality residential construction. Strong, layered sidewalls pair with precisely placed C-channel aluminum studs set 16 inches on-center, while a robust truss-built roof protects your investment for the long haul. Inside, premium flooring adds stability and comfort, and durable aluminum-framed windows are built to stand the test of time, coming together to deliver a coach made to last.

Masterpiece Finish™

Every Newmar coach is finished with our Full-Paint Masterpiece Finish™, an industry-exclusive process crafted with premium BASF paints and applied entirely within our own 45,000-square-foot paint facility by skilled Newmar artisans. We were the first RV manufacturer to offer full-body paint across every model we build—a testament to our unwavering commitment to quality and our belief that your motorhome should be as beautiful on the outside as it is welcoming on the inside.



NEWMAR SERVICE

You deserve a seamless service experience from the day you take delivery onward. No matter what you need, your Newmar service team prioritizes getting it done and getting you back out on the road as soon as possible.

SERVICE FEATURES

Personal Service Tech

The Newmar Service Center offers personal service technicians and the ability to camp onsite with full hookups, receive in-depth education, use private workstations, visit with other Newmar owners in our lounge, and enjoy convenient laundry facilities along with dedicated pet lounges and a pet park.

NewServ Mobile

With NewServ, our technicians come to you for routine maintenance. Services like appliance fixes, water pump maintenance, and more are available in Southern California, Arizona, and Central Florida. To schedule your appointment, call **800-731-8300**.

Newgle for Product Knowledge

Explore Newgle—our free online knowledge base—packed with information straight from Newmar, as well as our component manufacturers and suppliers.

Dedicated Brand Specialists

Newmar Service Account Managers, otherwise known as Brand Specialists, provide dealer warranty service authorizations within four business hours, and ship all in-stock parts the same day, via free ground shipment. And if a part is out of stock, they'll either pull it from the production floor or order the part from the appropriate supplier immediately.



HARDWOOD CABINETRY OPTIONS

MESA (SHOWN IN IMAGE)



FEATURES

- + Maple Hardwood Cabinet Doors in Suede Finish
- + Available in Four Solid Colors and Three Two-Tone Finishes
- + Concealed Cabinet Door Hinges
- + Soft-Close Cabinet Drawers
- + Dovetail Cabinetry Drawers With Full Extension Ball Bearing Guides

CABINET COLOR OPTIONS

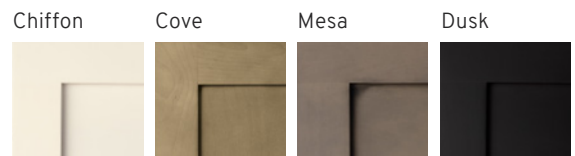

TWO-TONE



INTERIOR DECOR OPTIONS

STOWE (SHOWN IN IMAGES)



Leather Furniture & Ceiling Accent

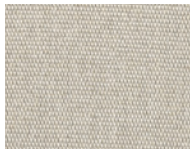

Dinette Chair & Pillows



Bedspread & Bedroom Windows



Bed Pillow

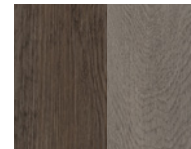

Vinyl Flooring Options



Countertops

ARLO



Leather Furniture & Ceiling Accent



Dinette Chair & Pillows



Bedspread & Bedroom Windows

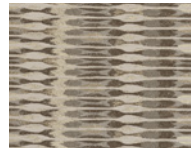

Bed Pillow

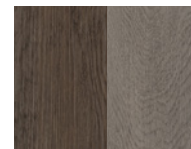

Vinyl Flooring Options



Countertops

VISTA



Leather Furniture & Ceiling Accent



Dinette Chair & Pillows



Bedspread & Bedroom Windows



Bed Pillow

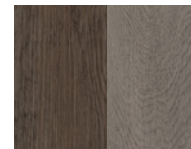

Vinyl Flooring Options

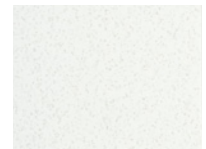

Countertops

Exterior color and interior décor options may be matched to customer preference, subject to availability. Please see your dealer for details.

EXTERIOR DESIGN OPTIONS



DRIFTSTONE

Charcoal Tweed Awning

INDIGO TIDE

Charcoal Tweed Awning



HARBORLINE

Charcoal Tweed Awning



FEATURES

- + Industry-Exclusive Full-Paint Masterpiece Finish™ with Clearcoat and Cut and Buff
 - + Ability to Customize Color Selections
 - + New Exterior Graphics and Colors with Three Color Combinations*
 - + Front Cap Diamond Shield Protection
- *New for 2027*

Exterior color and interior décor options may be matched to customer preference, subject to availability. Please see your dealer for details.

COCKPIT

KEY FEATURES

- + Driver Assistance Package
- + Driver Seat with Six-Way Power, Passenger Seat with Manual Foot Rest
- + Drop-Down Bunk Above Cockpit (Optional)
- + Dash Camera Prep (Optional)*
- + Folding Cockpit Table (Optional)

*New for 2027



POPULAR UPGRADES

- + Drop-Down Bunk Bed Over Driver and Passenger Seats with Bunk Ladder and Overhead Cabinet
- + Folding Cockpit Table

CABIN

KEY FEATURES

- + 74" Comfort Lounge Sofa Across from Sleeper Booth Dinette (Additional Seating Options Available)
- + Samsung® LED TV
- + 84" Ceiling Height for Added Comfort
- + Two 13.5K BTU Heat Pump Air Conditioners
- + Starlink Internet System (Subscription Required)
- + Pet Package Includes: Newmar-Branded Splash-Proof Water and Food Bowls, Exterior Leash Hook and Retractable Pet Gate (Optional)*

*New for 2027



POPULAR UPGRADES

- + 84" Theater Seating (Manual) with Reading Lights Replaces Comfort Lounge Sofa
- + High-Performance Starlink Internet System (Subscription Required)

GALLEY & DINETTE

KEY FEATURES

- + Patio-Side Booth Dinette Sleeper (Additional Dinette Options Available)
- + 10 Cu. Ft. Norcold® Refrigerator
- + 30" Stainless Steel Convection Microwave with Air Fryer Feature
- + Three-Burner Cooktop
- + Kitchen Pantry
- + Dovetail Cabinetry Drawers*

*New for 2027



POPULAR UPGRADES

- + Euro Booth Dinette with One Table Leaf Replaces Standard Booth Dinette
- + 11 Cu. Ft. Whirlpool® Refrigerator

BEDROOM

KEY FEATURES

- + King-Size Bed with Pillow Top Mattress—
The Shortest Bay Star Floor Plan to Offer
This Feature**
- + Samsung® LED TV
- + Lighted Wardrobe
- + Dresser Drawers
- + Large 30" x 73" Bunks with Option to Convert to
Dedicated Office with Built In Desk, Chair and
Window (Floor Plan 3640)*

*New for 2027

**Bed size varies by floor plan



BATHROOM

KEY FEATURES

- + Full Midship Bath
- + Large 40" x 30" Shower*
- + Polished Solid-Surface Countertops
- + Linen Vanity Cabinets
- + Stacked Two-Piece Splendide® Washer and Dryer (Optional)

*Shower sizes vary by floorplan

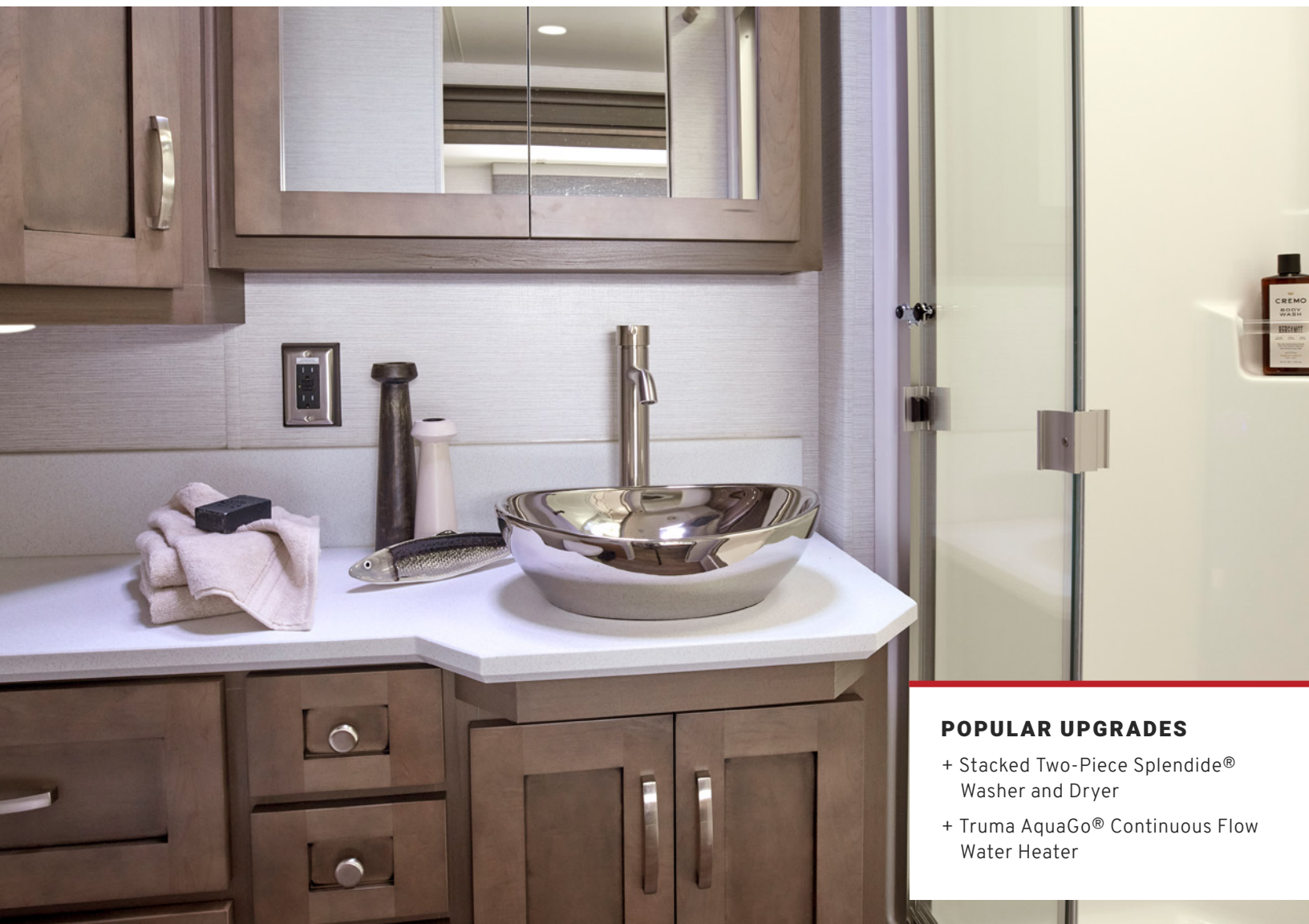

POPULAR UPGRADES

- + Stacked Two-Piece Splendide® Washer and Dryer
- + Truma AquaGo® Continuous Flow Water Heater

EXTERIOR FEATURES

KEY FEATURES

- + Industry-Exclusive Full-Paint Masterpiece Finish™ with Clearcoat and Cut and Buff
- + Carefree Travel'r Awning
- + Three New Graphic Design and Color Options*
- + Lighted Basement Storage
- + Exterior Entertainment Center in Sidewall with 32" Samsung® LED TV, AM/FM Radio, and Speakers (Optional)

*New for 2027



POPULAR UPGRADES

- + Exterior Entertainment Center in Sidewall with 32" Samsung® LED TV, AM/FM Radio, and Speakers
- + Flag Pole Bracket

Our Best-Selling Bay Star Floor Plan

3114 FLOOR PLAN

STANDARD

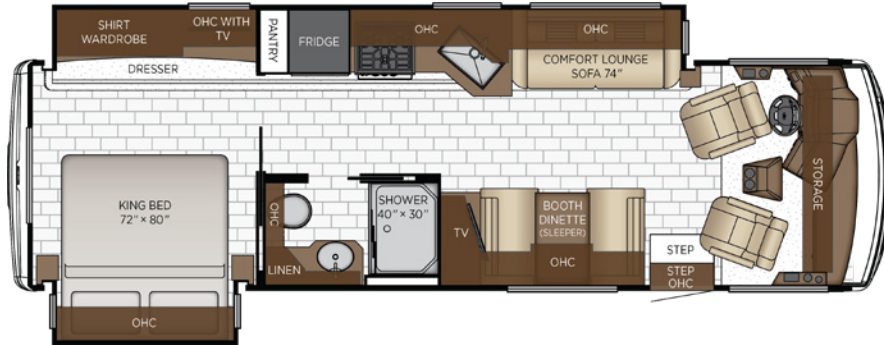

OPTIONS

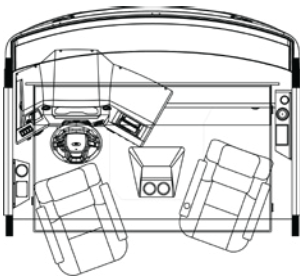

Drop Down Bunk

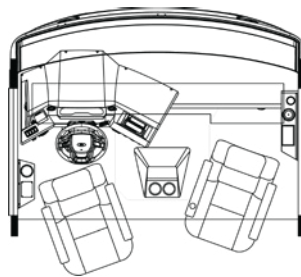

Front TV Overhead Cabinet

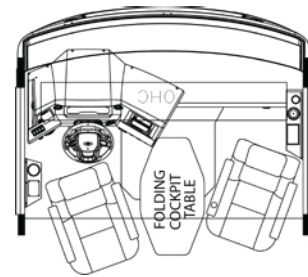

Folding Cockpit Table

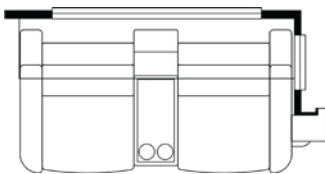

Theater Seating

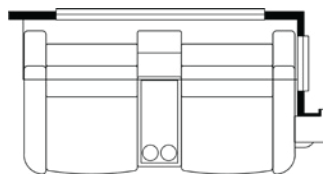

Trifold Sofa

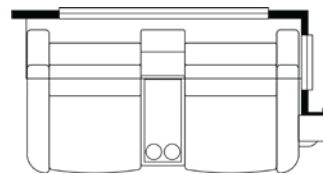

Euro Booth Dinette



Norcold 15 CF 3 Door Fridge - Removes Pantry

PERFECT FOR

- + Those Seeking Agility in a Class A
- + Those Desiring Patio-Side Views

Length	31' 11"	Interior Height	84"	Furnace	35,000 BTU
Width	101.5"	Grey Tank	60 gal.	Sleeps	2-5 People
App. Overall Height	12' 10"	Sewage Tank	40 gal.		
Interior Width	95.5"	Water Tank	75 gal.		

3225 FLOOR PLAN

STANDARD



OPTIONS

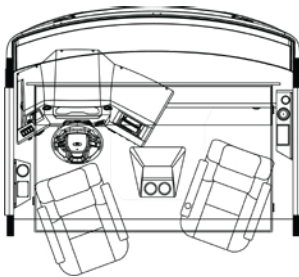

Drop Down Bunk

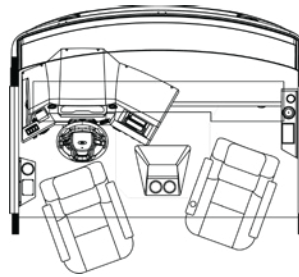

Front TV Overhead Cabinet

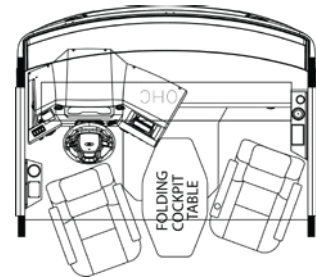

Folding Cockpit Table

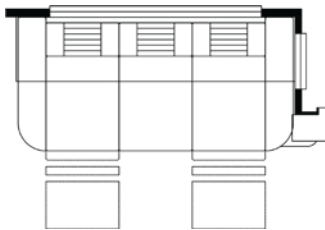

Non Sleeper Inclinor Sofa

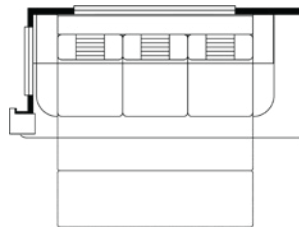

Trifold Sofa

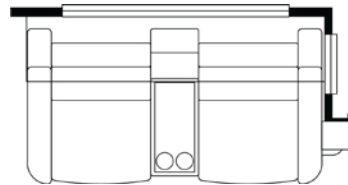

Euro Booth Dinette

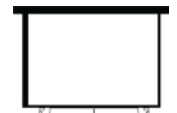

Norcold 15 CF 3 Door Fridge - Removes Pantry

PERFECT FOR

- + National Park Enthusiasts and Those Seeking a More Compact Class A
- + Those Seeking Patio-Side Views

Length	32' 11"	Interior Height	84"	Furnace	35,000 BTU
Width	101.5"	Grey Tank	60 gal.	Sleeps	2-6 People
App. Overall Height	12' 10"	Sewage Tank	40 gal.		
Interior Width	95.5"	Water Tank	75 gal.		

3609 FLOOR PLAN

STANDARD

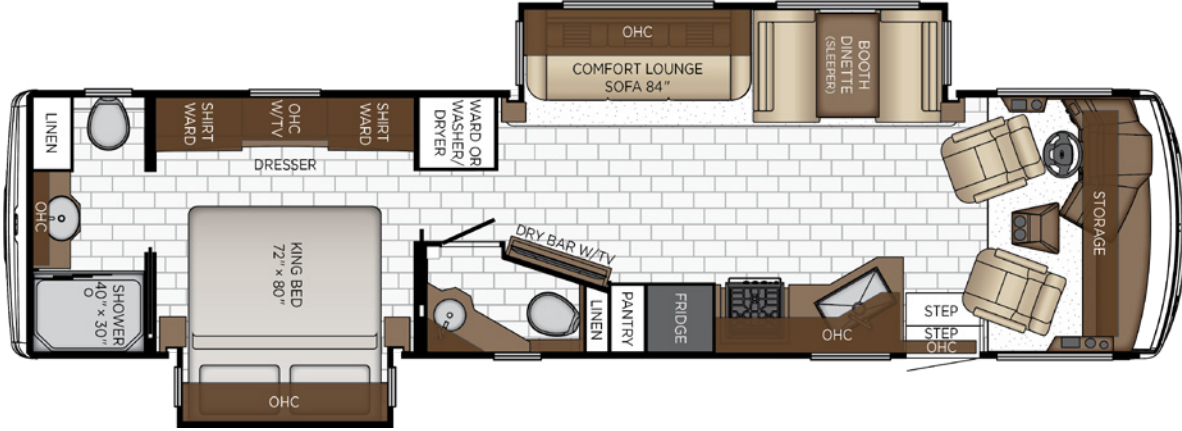

OPTIONS

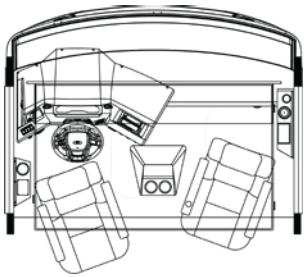

Drop Down Bunk

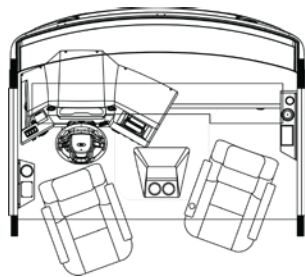

Front TV Overhead Cabinet

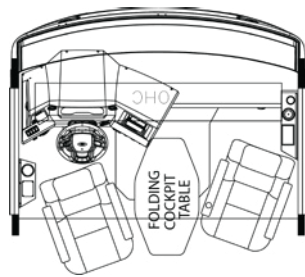

Folding Cockpit Table

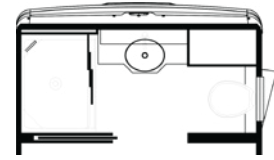

Egress Door



Norcold 15 CF 3 Door Fridge - Removes Pantry

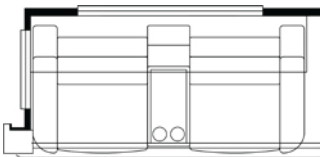

Theater Seating

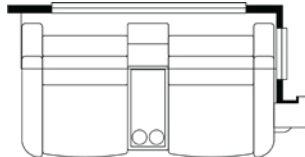

Euro Booth Dinette

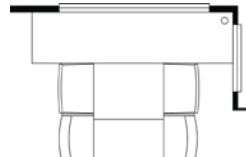

Buffet Dinette with Combo Desk



Combo Desk with Free Standing Dinette

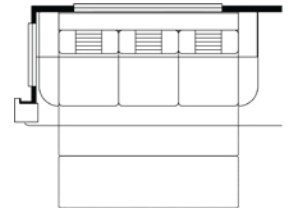

Trifold Sofa

PERFECT FOR

- + Stadium Tailgaters and National Park Enthusiasts
- + Hosts Who Love Thoughtful Amenities Such as a Dry Bar
- + Those Desiring Options to Provide Maximum Comfort on Longer Trips

Length	36' 11"	Interior Height	84"	Furnace	35,000 BTU
Width	101.5"	Grey Tank	60 gal.	Sleeps	2-6 People
App. Overall Height	12' 10"	Sewage Tank	40 gal.		
Interior Width	95.5"	Water Tank	75 gal.		

3626 FLOOR PLAN

STANDARD

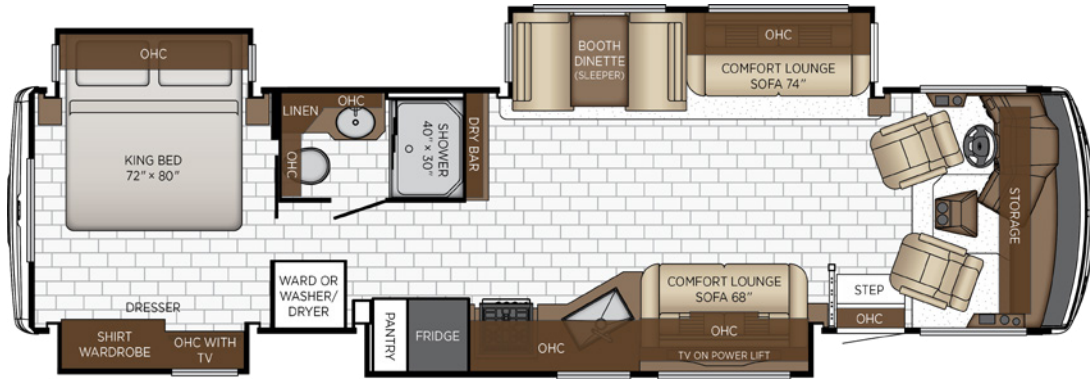

OPTIONS

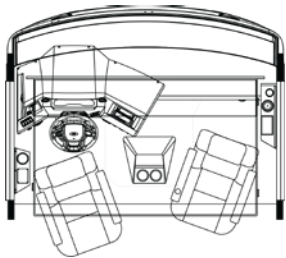

Drop Down Bunk

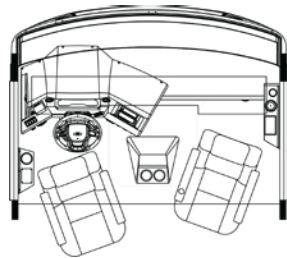

Front TV Overhead Cabinet

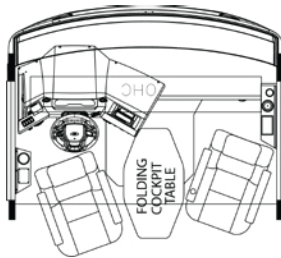

Folding Cockpit Table

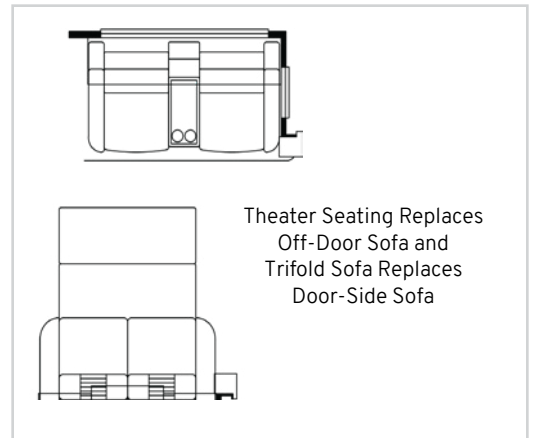

Theater Seating Replaces Off-Door Sofa and Trifold Sofa Replaces Door-Side Sofa

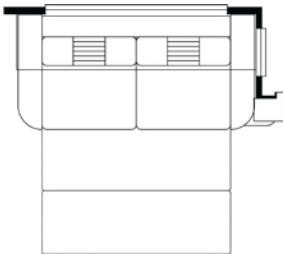

Trifold Sofa

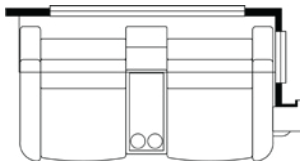

Theater Seating

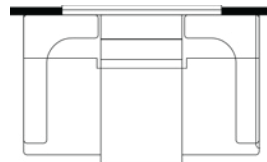

Euro Booth Dinette



Norcold 15 CF 3 Door Fridge - Removes Pantry

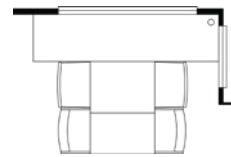

Combo Desk with Buffet Table

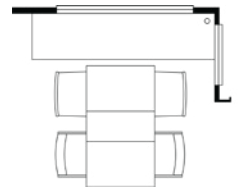

Combo Desk with Free Standing Dinette

PERFECT FOR

- + Stadium Tailgaters and National Park Enthusiasts
- + Hosts Who Love Thoughtful Amenities Such as a Dry Bar
- + Maximum Comfort on Longer Trips

Length	36' 11"	Interior Height	84"	Furnace	35,000 BTU
Width	101.5"	Grey Tank	60 gal.	Sleeps	2-6 People
App. Overall Height	12' 10"	Sewage Tank	40 gal.		
Interior Width	95.5"	Water Tank	75 gal.		

3639 FLOOR PLAN

STANDARD



OPTIONS

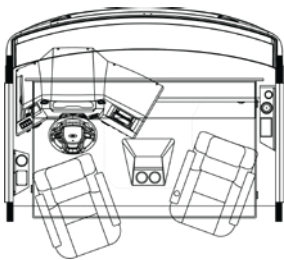

Drop Down Bunk

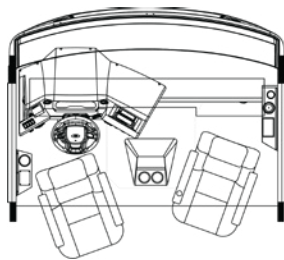

Front TV Overhead Cabinet

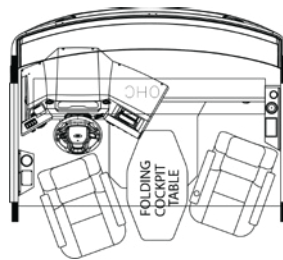

Folding Cockpit Table

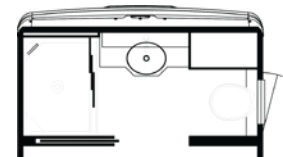

Egress Door

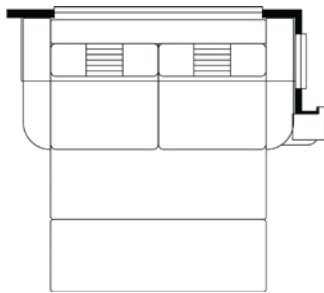

Trifold Sofa

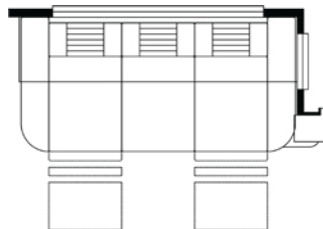

Non Sleeper Inliner Sofa

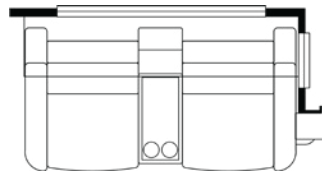

Euro Booth Dinette

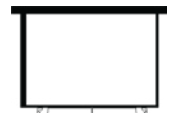

Norcold 15 CF
3 Door Fridge -
Removes Pantry

PERFECT FOR

- + Couples Seeking a Spacious Retreat
- + Hosts and Entertainers Desiring a Spacious Kitchen and Midship Half Bath

Length	36' 11"	Interior Height	84"	Furnace	35,000 BTU
Width	101.5"	Grey Tank	60 gal.	Sleeps	2-6 People
App. Overall Height	12' 10"	Sewage Tank	92 gal.		
Interior Width	95.5"	Water Tank	75 gal.		

3640 FLOOR PLAN

STANDARD

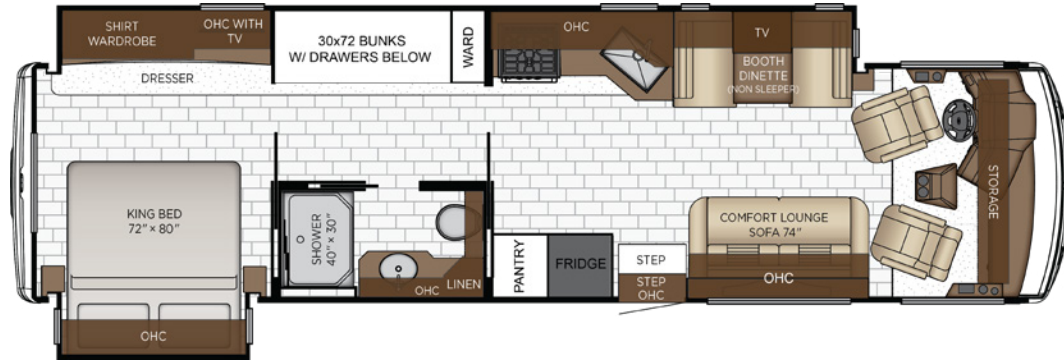

OPTIONS

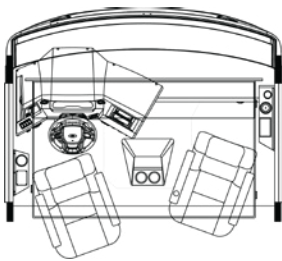

Drop Down Bunk

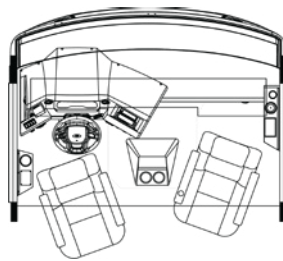

Front TV Overhead Cabinet

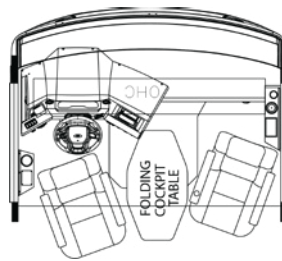

Folding Cockpit Table

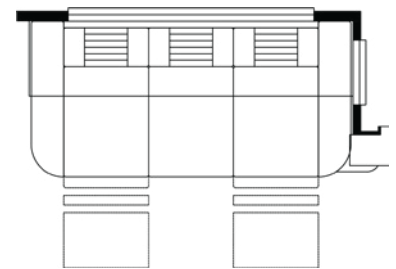

Non Sleeper Incliner Sofa

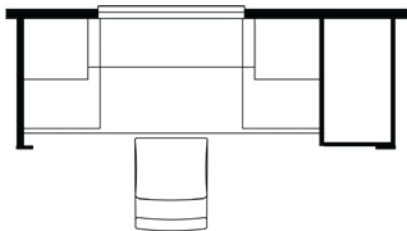

Desk Replaces Bunks

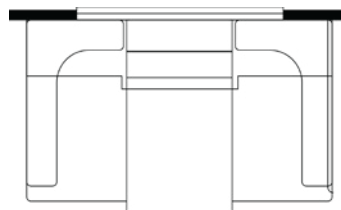

Non Sleeper Euro Booth Dinette



Norcold 15 CF 3 Door Fridge - Removes Pantry

PERFECT FOR

- + Families Seeking Spacious Bunks
- + Those Working From the Road Desiring the Option for a Private Workspace

Length	36' 11"	Interior Height	84"	Furnace	35,000 BTU
Width	101.5"	Grey Tank	60 gal.	Sleeps	2-6 People
App. Overall Height	12' 10"	Sewage Tank	92 gal.		
Interior Width	95.5"	Water Tank	75 gal.		

3811 FLOOR PLAN

STANDARD



OPTIONS

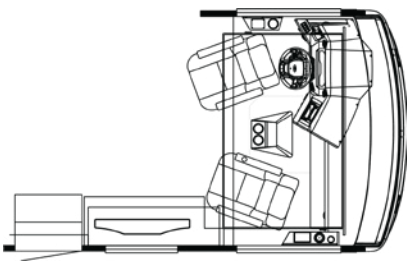

Drop Down Bunk with TV Lift with Fireplace, Omits 32\"/>

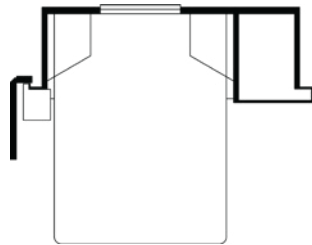

Lowered Bed Base with Freestyle Glideaway Adjustable Bed Mechanism with Window

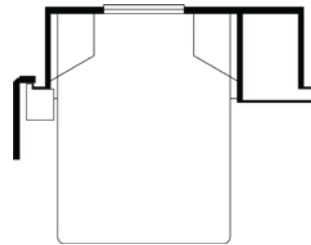

Powered Adjustable Height Bed Base with Window

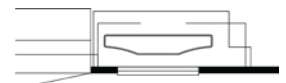

TV Lift with Fireplace



Sliding Screen Door Over Wheelchair Lift Area

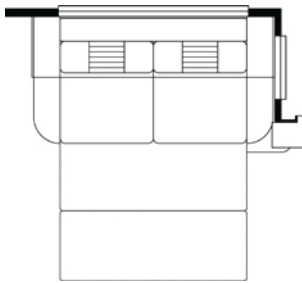

Trifold Sofa

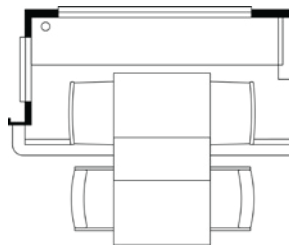

Combo Desk with Free Standing Dinette

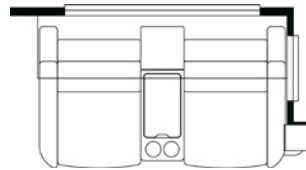

Theater Seating

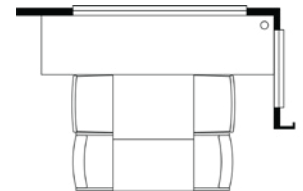

Buffet Dinette with Combo Desk

PERFECT FOR

+ Those Desiring an Accessible Coach

Length	38' 11"	Interior Height	84"	Furnace	42,000 BTU
Width	101.5"	Grey Tank	60 gal.	Sleeps	2-5 People
App. Overall Height	12' 10"	Sewage Tank	40 gal.		
Interior Width	95.5"	Water Tank	75 gal.		

FLOOR PLAN SPECIFICATIONS

FLOOR PLAN KEY FEATURES

+ 3114:

- **Perfect For:** Those Seeking Agility in a Class A, Those Desiring Patio Side Views
- **Key Features:** Our Best-Selling and Shortest Bay Star Floor Plan Allowing Easier Access to Small Spaces, Maneuverability, King-Size Bed, Patio-Side Dinette Sleeper, Midship Full Bath

+ 3225:

- **Perfect For:** National Park Enthusiasts and Those Seeking a More Compact Class A, Those Seeking Patio Side Views
- **Key Features:** Maneuverability, King-Size Bed, Patio-Side Dinette Sleeper, Full-Bath Midship, Easy Access to Small Spaces, Optional Cockpit Table

+ 3609:

- **Perfect For:** Tailgaters and National Park Enthusiasts, Hosts Who Love Thoughtful Amenities Such as a Dry Bar, Those Desiring Options to Provide Maximum Comfort on Longer Trips
- **Key Features:** 84" Comfort Lounge Sofa Dry Bar with TV, Booth Dinette Sleeper, King-Size Bed, Full Bath and Midship Half Bath

+ 3626:

- **Perfect For:** Tailgaters and National Park Enthusiasts, Hosts Who Love Thoughtful

Amenities Such as a Dry Bar, Those Desiring Options to Provide Maximum Comfort on Longer Trips

- **Key Features:** Opposing 74" Comfort Lounge and 68" Comfort Lounge Sofas, Dry Bar, Booth Dinette Sleeper, King-Size Bed, Midship Full Bath

+ 3639:

- **Perfect For:** Couples Seeking a Spacious Retreat, Hosts and Entertainers Desiring a Spacious Kitchen and Mid-Ship Half Bath
- **Key Features:** Theatre Seating, Choice of Midship Bunk Beds or Built-In Desk, Full Bath with Shower, Midship Half Bath, King-Size Bed

+ 3640:

- **Perfect For:** Families Seeking Spacious Bunks, Those Working From Home Desiring a Private Workspace
- **Key Features:** Choice of Private Bunk Beds or Walk-In Wardrobe in the Rear of the Coach, King-Size Bed, Midship Half Bath, Efficient Kitchen

 **+ 3811:**

- **Perfect For:** Those Desiring an Accessible Coach
- **Key Features:** Accessible Design, BraunAbility Lift, 30" Wide Aiseway, Roll-Under Dinette, Accessible Countertops, Queen-Size Bed, Midship Full Bath, Large 48" x 36" Roll-In Shower, Roll-Under Vanity

FLOOR PLAN SPECIFICATIONS

FLOOR PLAN	LENGTH	WIDTH	APP. OVERALL HEIGHT	INTERIOR WIDTH	INTERIOR HEIGHT	GREY TANK	SEWAGE TANK	WATER TANK	FURNACE	SLEEPS
3114	31' 11"	101.5"	12' 10"	95.5"	84"	60 gal.	40 gal.	75 gal.	35,000 BTU	2-5
3225	32' 11"	101.5"	12' 10"	95.5"	84"	60 gal.	40 gal.	75 gal.	35,000 BTU	2-6
3609	36' 11"	101.5"	12' 10"	95.5"	84"	60 gal.	40 gal.	75 gal.	35,000 BTU	2-6
3626	36' 11"	101.5"	12' 10"	95.5"	84"	60 gal.	40 gal.	75 gal.	35,000 BTU	2-6
3639	36' 11"	101.5"	12' 10"	95.5"	84"	60 gal.	92 gal.	75 gal.	35,000 BTU	2-6
3640	36' 11"	101.5"	12' 10"	95.5"	84"	60 gal.	92 gal.	75 gal.	35,000 BTU	2-6
3811	38' 11"	101.5"	12' 10"	95.5"	84"	60 gal.	40 gal.	75 gal.	42,000 BTU	2-5

The content in our literature depicts and describes products that are subject to change. For the most recent images and information, please visit NewmarCorp.com. Lengths, heights, widths, and dry weights are approximate. Weight will vary based on optional equipment added to the above base weight.

CHASSIS



CHASSIS

+ Ford® F53 Chassis with 7.3Ltr V-8 Engine

HORSE POWER

335_{HP}

Ford 7.3Ltr V-8 Engine

FUEL TANK

80_{GAL}

LENGTH

31-38_{FT}

TORQUE

468_{LB/FT}

AXLES

2

TIRE SIZE

22.5"

Michelin Brand
255/80R22.5G XRV

STEERING WHEEL

17.5" Black Vinyl,
Tilt Steering Wheel

SAFETY

- + Ford® Forward Collision Mitigation System
- + Adaptive Cruise Control
- + Distance Alert
- + Post Impact Braking
- + Lane Departure Warning
- + Electronic Stability Control

TRANSMISSION

TorqShift 6R140

CHASSIS SPECIFICATIONS

GLOSSARY

- + **GAWR:** Gross Axle Weight Rating is the maximum permissible weight for an axle.
- + **GVWR:** Gross Vehicle Weight Rating is the maximum permissible weight for a fully loaded motor coach.
- + **GCWR:** Gross Combination Weight Rating is the value specified by the manufacturer of the vehicle as the maximum allowable loaded weight of this motor coach and any towed trailer or towed vehicle.
- + **UVW:** Unloaded Vehicle Weight is the weight of this motor coach as built at the factory with full fuel, engine oil, and coolants. Does not include cargo, fresh water, propane gas, or dealer-installed accessories.
- + **NCC:** Net Carrying Capacity is the maximum weight of all occupants, including the driver, personal belongings, food, fresh water, waste water, propane gas, tools, tongue weight of towed vehicle, dealer-installed accessories, etc., that can be carried by the motor coach.
- + Specifications supplied by the chassis manufacturer.

FORD® F-53 CHASSIS												
FLOOR PLAN	ENGINE HP	AXLE RATIO	FUEL CAP.	WHEEL BASE	TIRE SIZE	FRONT GAWR	REAR GAWR	TAG GAWR	GVWR	GCWR	APP. UVW	APP. NCC
3114	335	6.14	80	210	22.5"	9000 lb.	17500 lb.	0	26000 lb.	30000 lb.	20050 lb.	5950 lb.
3225	335	6.14	80	228	22.5"	9000 lb.	17500 lb.	0	26000 lb.	30000 lb.	21450 lb.	4550 lb.
3609	335	6.14	80	242	22.5"	9000 lb.	17500 lb.	0	26000 lb.	30000 lb.	22700 lb.	3300 lb.
3626	335	6.14	80	242	22.5"	9000 lb.	17500 lb.	0	26000 lb.	30000 lb.	22600 lb.	3400 lb.
3639	335	6.14	80	242	22.5"	9000 lb.	17500 lb.	0	26000 lb.	30000 lb.	22700 lb.	3300 lb.
3640	335	6.14	80	242	22.5"	9000 lb.	17500 lb.	0	26000 lb.	30000 lb.	22700 lb.	3300 lb.
3811	335	6.14	80	254	22.5"	9000 lb.	17500 lb.	0	26000 lb.	30000 lb.	22850 lb.	3150 lb.

The content in our literature depicts and describes products that are subject to change. For the most recent images and information, please visit NewmarCorp.com. Lengths, heights, widths, and dry weights are approximate. Weight will vary based on optional equipment added to the above base weight.

STANDARD FEATURES & OPTIONS

EXTERIOR FEATURES

- Exterior Full-Paint Masterpiece Finish™ with Clearcoat and Cut and Buff
- Entrance Door Assist Handle
- Entrance Door Automatic Step
- Convex Exterior Mirrors with Defrost and Remote Control
- Front Cap Diamond Shield Protection
- Smart Level Hydraulic Leveling Jacks with Bluetooth Compatible Touchpad
- Mud Flaps
- Rear Hitch for Towing Car
- Undercoating

OPTIONS

- Flag Pole Bracket
- Rear Ladder
- Windshield Temporary Protection (For Transport Only)

CONSTRUCTION FEATURES

- 16" On-Center Aluminum Frame Sidewalls and Roof Construction
- Power Opening Entrance Door for Wheelchair Lift (3811 Only)
- 5.8" Foam Insulation Laminated in Sidewalls and Ceiling
- Gelcoated Fiberglass Exterior Sidewalls, Front and Rear Caps
- One-Piece Molded Fiberglass Roof
- Polar Pak R19 Batten Insulation in Roof
- Slideout Automatic Mechanical Lock Arms - Scissor Style

OPTIONS

- Egress Door with Ladder System (Floor Plan Specific)
- Entrance Step Well Power Cover (3811 Only)

WINDOWS, AWNINGS, & VENTS

- Carefree Travel'R Power Side Awning with Alumaguard and Strip Lighting
- Fan-Tastic® Vent with Rain Sensor in Kitchen and Bathroom
- Rear Window in Bedroom (Floor Plan Specific)
- Skylight Above Shower
- Slideout Covers
- Frameless Double-Pane Tinted Safety Glass Windows
- One-Piece Tinted Windshield

OPTIONS

- Screen Door Over Wheelchair Lift Area

CHASSIS FEATURES

- Anti-Lock Braking System
- Auto Emergency Brake, Distance Alert, Post Impact Braking, Lane Departure Warning
- Cruise Control
- Electronic Stability Control
- Ford® Forward Collision Mitigation System, Adaptive Cruise Control, Auto High Beams, Passive Entry

Ford® F-53 Chassis with 7.3L V-8 Engine - 26,000#

- Tilt Steering Wheel
- Aluminum Wheels

OPTIONS

- Ford® F-53 Chassis with 7.3L V-8 Engine - 26,000#, Canada

AIR CONDITIONING & HEATING

- Two 13.5K BTU Heat Pump Conditioners
- Dash Heater and Air Conditioner
- Defrost Fans Built Into Front Overhead
- Furnace Propane Gas with Ducted Heat

OPTIONS

- Auxillary Heater in Rear of Coach

ELECTRICAL FEATURES

- Automatic Generator Start On Low Battery or Temperature Setting
- Battery Disconnect Switch for House Battery
- Cable TV Connection
- Dash Radio, Cameras and Monitors to Power Up from Both House Batteries and Ignition
- Daytime Running Lights
- Drain Lift Pump (Floor Plan Specific)
- 50 Amp Electrical Service with Flexible Cord and Automatic Transfer Switch
- Emergency Engine Start Switch
- Energy Management System
- Six 6V House Batteries
- 2000W Victron Invertor with CPAP Prep
- LED Light on Awning
- LED Lights in Ceiling
- Lights in Exterior Storage Compartments
- Lights in Wardrobes
- Multiplex Lighting Control System
- 10.1" Multiplex Monitor System in Center of Coach with Interior Lighting and HVAC Controls
- Newmar App
- 5.5kW Cummins Onan® Generator with One Remote Switch and Automatic Changeover
- Power Rewind Reel with 33' Cord (Floor Plan Specific)
- 12V Recept Auxillary on Dashboard
- Slideout Switch Manually Operated
- 10W Solar Panel to Charge Chassis Battery
- USB Outlet at Dash for Driver Use
- USB Outlet at Passenger Seat Area
- Wireless Phone Charger (2) in Cockpit

OPTIONS

- Dash Camera Prep
- Solar Prep with 6 Gauge Wire Ran From Roof to First Storage Compartment

STANDARD FEATURES & OPTIONS (CONTINUED)

PLUMBING & BATH FEATURES

Six-Gallon Gas/Electric Water Heater with Electronic Ignition

Exterior Shower Located on Off-Door Side

Sewage Holding Tank Rinse

Fiberglass Shower Surround with Shower Door

Dometic® 310 China Bowl Stool

Systems Monitor Panel

Water Filter

Water Heater Bypass System

OPTIONS

110V Heat Pads for Holding Tanks

Truma AquaGo Continuous Flow Water Heater

INTERIOR FEATURES

Auto Motion Manual Double Rollar Shades on Windows Behind Driver and Passenger Area

Auto Motion Power Shade at Windshield and Manual Shades at Driver and Passenger Side Windows

Fitted Non-Quilted Bedspread and Accent Pillow

ABS Color-Coordinated Dash Panel

Decorative Wall Art

Integrated Window Blind System on Entry Door

Interior Passage Inlaid Six Panel Design Doors

Interior Assist Handle at Main Entry Door

Padded Vinyl Ceiling Panels

Shoe Storage Located in Entrance Door Step Compartment

Vinyl Plank Floor in Kitchen, Bathroom, Bedroom and Living Areas

Waste Basket in Kitchen Base Under Sink

Woven Material on Slideout Floors

OPTIONS

Pet Package: Includes Newmar-Branded Splash-Proof Water and Food Bowls, Exterior Leash Hook and Retractable Pet Gate

CABINETS & FURNITURE

Bed Base Lowered with Power Incline Head of Bed and Deluxe Air Mattress on Floor Plan 3811

Concealed Cabinet Door Hinges

Soft-Close Cabinet Drawers

Dovetail Cabinetry Drawers

Polished Solid-Surface Countertop in Kitchen, Undermount Sink and Sink Covers

Solid-Surface Countertop in Bathroom and Bedroom

Williamsburg Sleeper Dinette Booth

Dinette with Power Adjustable Table, Bench Seat and Folding Chair on Floor Plan 3811

Drawers Underneath Dinette Booth Seats

Driver Seat with Six-Way Power

Lifts on Bed Top

Plush Pillow Top Mattress

Molded Silverware Divider Tray

Pullout Pantry Shelves (See Floor Plans for Availability)

Passenger Seat Tablet Holder

Passenger Seat with Manual Foot Rest

Williamsburg Sofa and Front Seats

OPTIONS

Full-Height Bed Base (Floor Plan 3811)

Lowered Bed Base (Fixed) with Freestyle Glideaway Adjustable Bed Mechanism, Air Mattress and Window (Floor Plan 3811)

Power Adjustable-Height Bed Base with Freestyle Glideaway Bed Mech, Air Mattress and Window (Floor Plan 3811)

Drop Down Bunk Bed Over Driver and Passenger Seats Extends to Windshield with Bunk Ladder and Overhead Cabinet

Drop Down Bunk Bed Over Driver and Passenger Seats Extends to Windshield with Bunk Ladder, Fireplace with TV and Soundbar (Floor Plan 3811)

Combo Desk Dinette with Buffet Table, Two Fixed and Two Folding Chairs

Combo Desk Dinette with Free Standing Hidden Leaf Table, Two Fixed and Two Folding Chairs

Euro Booth Dinette with One Table Leaf Replaces Standard Booth Dinette

Folding Cockpit Table

74" Incliner Non-Sleeper Sofa Replaces Comfort Lounge

68" Visionary V2 Trifold Sofa with Memory Foam Mattress Replaces Comfort Lounge

74" Visionary V2 Trifold Sofa with Memory Foam Mattress Replaces Comfort Lounge

84" Visionary V2 Trifold Sofa with Memory Foam Mattress Replaces Comfort Lounge

68" Theater Seating (Manual) with Reading Lights Replaces Comfort Lounge Sofa

74" Theater Seating (Manual) with Reading Lights Replaces Comfort Lounge Sofa Off-Door Side, 68" Trifold Sofa in Lieu of Comfort Lounge Door Side

74" Theater Seating (Manual) with Reading Lights Replaces Comfort Lounge Sofa

Desk and Chair Replaces Bunks (Floor Plan 3640)

84" Theatre Seating (Manual) with Reading Lights Replaces Comfort Lounge Sofa

APPLIANCES & ACCESSORIES

30" Convection Stainless Steel Microwave with Air Fryer Feature with Three-Burner Recessed Cooktop

Convection Microwave Below Cooktop on Floor Plan 3811

10 Cu. Ft. Norcold® Refrigerator

Six-Gallon Gas/Electric Water Heater with Electronic Ignition

STANDARD FEATURES & OPTIONS (CONTINUED)

OPTIONS
<input type="checkbox"/> 30" Stainless Steel Microwave Convection with Air Fryer Feature in Kitchen Overhead with Drawer Below Cooktop
<input type="checkbox"/> 15 Cu. Ft. Norcold® Three-Door Refrigerator with Icemaker
<input type="checkbox"/> 11 Cu. Ft. Whirlpool® Refrigerator
<input type="checkbox"/> 11 Cu. Ft. Whirlpool® Refrigerator with Ice Maker
<input type="checkbox"/> Washer and Dryer Prep
<input type="checkbox"/> Stacked Two-Piece Splendide® Washer and Dryer

AUDIO, VIDEO & ACCESSORIES

10" Single Monitor Axxera Dash Radio with Android Auto™ and Apple CarPlay® and SiriusXM® Ready
Side View Cameras Displayed onto Rear View Monitor Screen
180W Dash Radio with Harman/JBL Sound System
10 BC Fire Extinguisher, Carbon Monoxide, Propane & Smoke Detectors
High Definition Component Wiring
Rear View Color Monitor System with Audio
Satellite Dish Prep on Roof
TV Jack and 110V Recept in Door Side Exterior Storage Compartment
Samsung® LED TV in Living and Bedroom Areas (TV Sizes Vary Per Floor Plan)
Starlink Internet System (Subscription Required)

OPTIONS
<input type="checkbox"/> Exterior Entertainment Center in Sidewall with 32" Samsung® LED TV, AM/FM Radio and Speakers
<input type="checkbox"/> Bose® Soundbar Sound System (Not Available with Bunk Option on 3811)
<input type="checkbox"/> High-Performance Starlink Internet System (Subscription Required)
<input type="checkbox"/> 32" Samsung® LED TV in Front Overhead (Not Available with Drop Down Bunk Option)
<input type="checkbox"/> 43" Samsung® TV on Televator with Fireplace in Place of Front Overhead TV (Floor Plan 3811 Only)
<input type="checkbox"/> Everest WiFi System with Aspen Interior Router
<input type="checkbox"/> Winegard® Rayzar Automatic Digital TV Antenna

OUR PARTNERS

THE NEWMAR DIFFERENCE™

The Newmar Difference™ begins with suppliers dedicated to providing our customers with unrivaled quality, comfort, and support. We only work with suppliers that are dedicated to providing our customers with unrivaled innovation, comfort, and reliability. It's all so you can experience best-in-class performance from names you can trust. At Newmar, that's our difference, and our promise.



BASF

The Coatings division of BASF is a global expert in the development and production of innovative and sustainable OEM and refinish coatings. Coatings by BASF—solutions beyond your imagination.



Freightliner® Custom Chassis

Freightliner® Custom Chassis are renowned for their exceptional ride, excellent maneuverability, advanced technology, and nationwide 24/7 factory-direct support.



Spartan® RV Chassis

An American company with over 40 years of experience in designing and manufacturing the premier motorhome chassis, Spartan® delivers superior performance, exceptional safety ratings, and industry-leading technology.



Industrial Finishes

Industrial Finishes has supported RV manufacturers for over four decades, offering paint products that deliver uncompromising quality and provide your coach with a true Masterpiece™ finish.



RiverPark

From Samsung® 4K TVs and Xite Infotainment systems to Bose® soundbars and JBL and Infinity premium audio systems, RiverPark helps ensure you enjoy the ultimate audio-visual technology in your Newmar coach.

THE NEWMAR CUSTOMER EXPERIENCE

The Newmar Difference™ goes beyond our industry-leading motor coaches to provide you with an unrivaled ownership experience.



Crafted with Purpose

Every Newmar is crafted one at a time by folks who have spent an average of eight years building them. Each coach we assemble must undergo more than 1,000 tests and checks before ever leaving our factory.



More Than a Number

Meet fellow owners through the Newmar Kountry Klub, a top social club for RV travelers that hosts rallies and other special events throughout the U.S. and Canada.



The Highest Standards

We view our dealership network in terms of quality, not quantity. Each of our dealers acts as a partner in our shared mission to exceed your highest of expectations, for an ownership experience that's second to none from day one.



Seamless Service

When you join the Newmar family, we pair you with a dedicated service specialist with expert knowledge of your exact coach. Our service specialists guarantee dealer warranty authorizations within four business hours and ship all in-stock parts the same day, free of charge.



Built Around You

As a Newmar owner, you'll find resources specific to your coach through Newgle, an easy-to-use knowledge base that houses everything from user guides to technical support documents.



Without Compromise

All models include a one-year/unlimited mileage limited warranty and a five-year, non-transferable structural warranty that covers your coach's superstructure in the event it fails to perform. Ask your Newmar dealer for more details.

CONTACT

Newmar Corporation
1952 Cheyenne St.
Nappanee, IN 46550

+ Phone: 574-773-7791
+ Fax: 574-773-2895
+ NewmarCorp.com

