

2024 LUXURY MOTORCOACH

ESSEX



NEWMAR





## Opulence every day—a lifetime of luxury

The 2024 Essex is perfect for those who really value refinement in their travel. Those who demand the finer things and simply won't settle for less. With a style all its own and numerous features and options to help you tweak the coach to your own preferences, the Essex will lead to more inspired destinations.

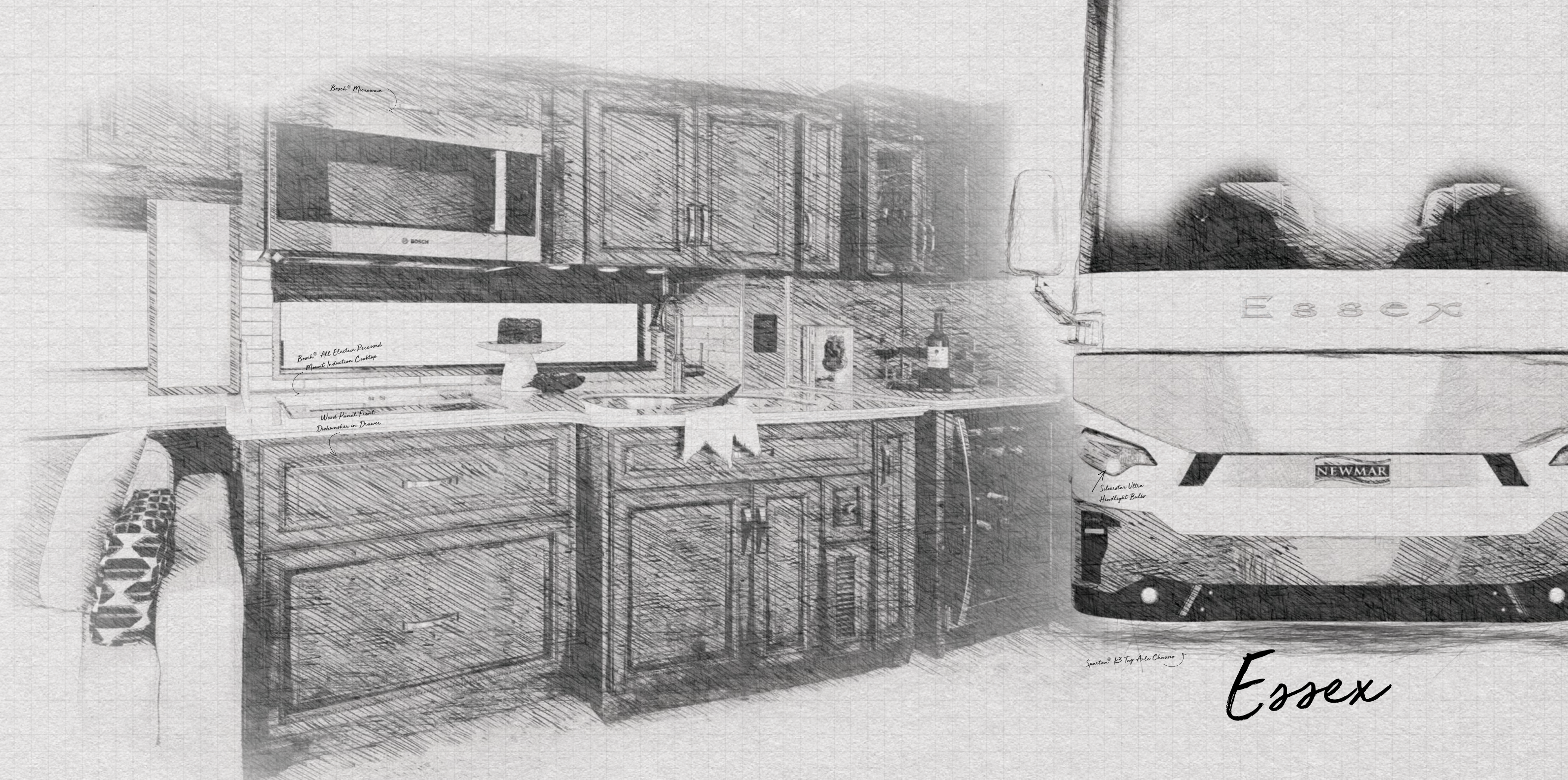

# Essex



# Spartan® K3 Tag Axle Chassis



45' / 4 floor plans

Cummins X15  
Diesel Engine

605 HP

1950 lb./ft. torque

Versailles Full-Paint  
Masterpiece Finish™  
Exterior





# Cockpit

**Leather-Trimmed Steering Wheel**

**Industry-First Comfort Drive™ Adaptive Steering**

**Mobileye® Lane Tracking  
and Departure System**

**OnGuard™ Collision Mitigation  
Adaptive Cruise System**

Adjustable Following Distance Control

**Valid Digital Glare-Free Dash**

**Heated and Cooled Captain's Seats**

Power-Lumbar, Recline, and Footrest  
Passenger Seat Workstation

**Xite Dash Radio**

10" Dual Monitor	360 Camera System
Nav-N-Go	Tri-View Rear Camera
Navigation System	Predictive Grid Lines
Apple CarPlay®	

**Passenger-Side Monitor** (Optional)

**Wireless Charging Mats**







Floor plan 4595 with Sanremo décor  
and Sedona cabinets

## Cabin

**Four Décor Options:  
Sanremo,\* Broderick,\* Hepburn,  
and Paragon**

**Villa Ultraleather Hide-A-Bed Sofa  
and Jack Knife Sofa\*\***

**50" Samsung\* 4K LED TV on Televator**

Bose® 900 Soundbar

Bose® 500 Subwoofer

**Bonded Bay-Like Windows**

*\*New for 2024*

*\*\*See Features and Options for all available furniture configurations*





# Cabin

Three 15K BTU Penguin™ Heat Pump  
Central Air Conditioners

Electric Radiant Heat Beneath  
Main Floor Tile

Beverage Center\*\*

WiFiRanger Denali System  
with Spruce Router

SilverLeaf® Monitor

\*\*Available exclusively on floor plan 4595



Floor plan 4595 with Sanremo décor and Sedona cabinets





# Galley & Dinette

**21.6 Cu. Ft. Bosch® Refrigerator\***

**Bosch® Microwave**

**Bosch® All Electric Recessed Mount  
Induction Cooktop\***

**Wood Panel Front Dishwasher in Drawer**  
(Optional)

**Glazed Maple Hardwood Cabinets**

Available in Four Matte or Three Ultra High  
Gloss Finish Options

Soft-Close Cabinet Doors  
LED Lights

**Large Pantry**

Pull-Out Shelves  
Dedicated Serving Tray/Bakeware Space  
Electric Travel Door Lock System  
LED Lights

**Super Polished Solid-Surface  
Countertops**

**Kitchen Window** (Optional)

**Euro Booth Dinette\***

Two Table Leaves  
Two Folding Chairs



*\*Additional dinette configurations available; see Features and Options for details*





# Bedroom

**King-Size Adjustable-Support Air Bed**

**Samsung® LED TV**  
Bose® Bedroom Speaker

**Lighted Wardrobe**  
Cedar Paneling  
Safe  
Pull-Out Shoe Storage\*

*\*Floor plan specific.*





# Bathroom

## Mid-Ship Bath

Lighted Vanity Mirrors

Fully Tiled Shower Walls and Floor\*

Aqua Miser® Shower System

Chinook Dual Loop Heat with Continuous Water

Splendide® Two-Piece Stacked Washer and Dryer\*\*

Super-Polished Solid-Surface Countertop

Cathedral Ceiling for Added Height¹

\*Shower sizes vary by floor plan  
\*\*New for 2024  
¹Available exclusively on rear bath floor plans







# Exterior & Storage

## Industry-Exclusive Full-Paint Masterpiece Finish™ with Cut and Buff

New Exterior Design with  
Five Color Combinations\*

## SilverStar Ultra Headlight Bulbs

## Push-Button Exterior Baggage Doors

Power Soft-Closing System

## 3.0 Cu. Ft. Dometic® Freezer on Pull-Out Tray

## Exterior Entertainment Center (Optional)

43" Samsung® 4K LED TV  
Bose® Soundbar

\*New for 2024  
\*\*Standard on floor plans 4521, 4551, and 4595





# Exterior

## Lithium Ion Battery System

Two Lithionics 320 AHR Battery Packs  
Surge Guard Transfer Switch

## Industry-Exclusive STAR Foundation

12.5 kW Cummins Onan®  
Diesel Generator

10W Solar Panel (to charge chassis battery)









*interior & exterior*  
**Design Options**





# Alnwick



Awning Color: Linen Tweed

## **BRODERICK INTERIOR** a. Furniture/Fabric b. Flooring c. Counter Top



*\*Exterior colors and interior décor options can be matched to customer preference.*

## **CABINET FINISHES**



*\*Pearl available exclusively in Matte Finish; Driftwood, Sable, and Sedona available in Matte and Ultra High Gloss.*



# Annecy



Awning Color: Charcoal Tweed

## HEPBURN INTERIOR a. Furniture/Fabric b. Flooring c. Counter Top



## CABINET FINISHES



\*Exterior colors and interior décor options can be matched to customer preference.

\*Pearl available exclusively in Matte Finish; Driftwood, Sable, and Sedona available in Matte and Ultra High Gloss.



# Chantilly



Awning Color: Charcoal Tweed

## PARAGON INTERIOR a. Furniture/Fabric b. Flooring c. Counter Top



\*Exterior colors and interior décor options can be matched to customer preference.

## CABINET FINISHES



\*Pearl available exclusively in Matte Finish; Driftwood, Sable, and Sedona available in Matte and Ultra High Gloss.



# Edinburgh



Awning Color: Charcoal Tweed

## SANREMO INTERIOR a. Furniture/Fabric b. Flooring c. Counter Top



## CABINET FINISHES



\*Exterior colors and interior décor options can be matched to customer preference.

\*Pearl available exclusively in Matte Finish; Driftwood, Sable, and Sedona available in Matte and Ultra High Gloss.



# Versailles



Awning Color: Charcoal Tweed



\*No matching interior décor for Versailles

## CABINET FINISHES



\*Pearl available exclusively in Matte Finish; Driftwood, Sable, and Sedona available in Matte and Ultra High Gloss.



# Floor Plan Specifications



Length: 44' 10"

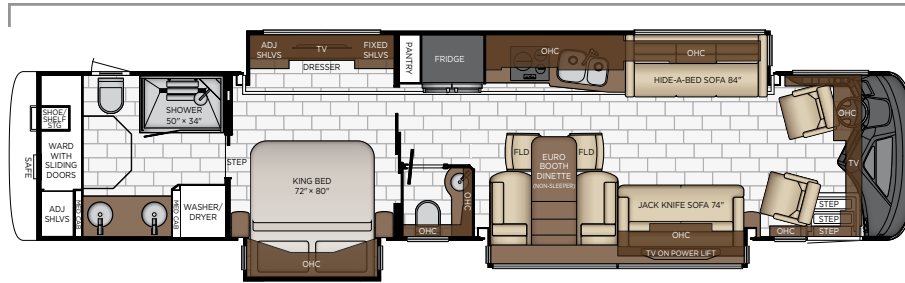

**4521**

Length	44' 10"	Grey Tank	80 gal.
Width	101.5"	Sewage Tank	60 gal.
App. Overall Height	13' 04"	Water Tank	105 gal.
Interior Width	95.5"	Propane Tank	0 gal.
Interior Height	83"	Furnace	50,000 btu

Length: 44' 10"

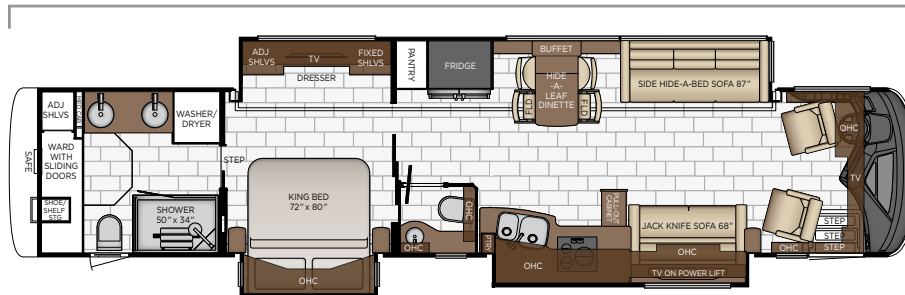

**4551**

Length	44' 10"	Grey Tank	80 gal.
Width	101.5"	Sewage Tank	60 gal.
App. Overall Height	13' 04"	Water Tank	105 gal.
Interior Width	95.5"	Propane Tank	0 gal.
Interior Height	83"	Furnace	50,000 btu



Length: 44' 10"

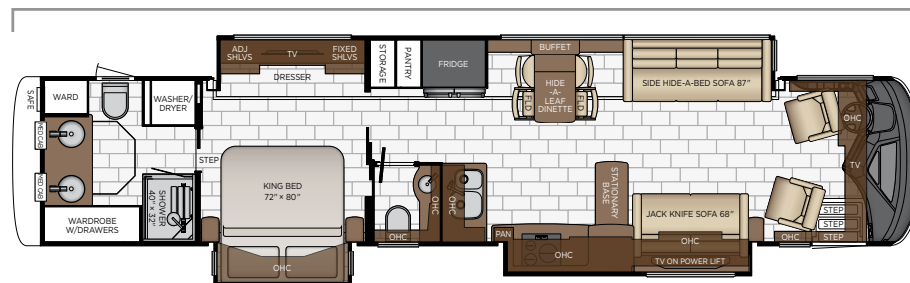

**4569**

Length	44' 10"
Width	101.5"
App. Overall Height	13' 04"
Interior Width	95.5"
Interior Height	83"

Grey Tank	80 gal.
Sewage Tank	60 gal.
Water Tank	105 gal.
Propane Tank	0 gal.
Furnace	50,000 btu

Length: 44' 10"

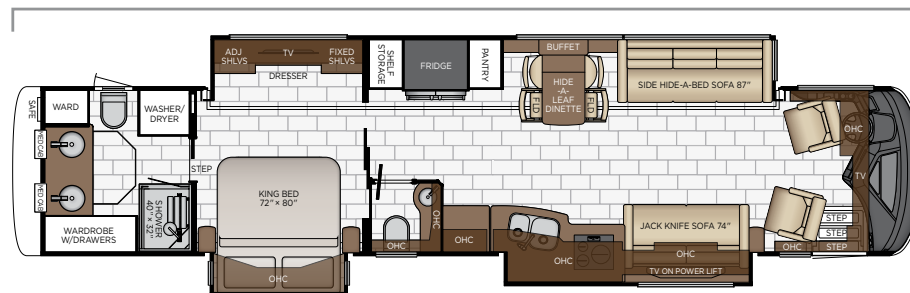

**4595**

Length	44' 10"
Width	101.5"
App. Overall Height	13' 04"
Interior Width	95.5"
Interior Height	83"

Grey Tank	80 gal.
Sewage Tank	60 gal.
Water Tank	105 gal.
Propane Tank	0 gal.
Furnace	50,000 btu



# Quality You Can Feel

Like a fine home, the 2024 Essex is framed 16 inches on center and is covered by a fiberglass roof with an integrated gutter rail.

SPARTAN®											
FLOOR PLAN	ENGINE HP	AXLE RATIO	FUEL CAP.	WHEEL BASE	FRONT GAWR	REAR GAWR	TAG GAWR	GVWR	GCWR	APP. UVW	APP. NCC
4521	605	4.3	150 gal.	292+TAG	20000 lb.	20000 lb.	14000 lb.	54000 lb.	74000 lb.	47200 lb.	6800 lb.
4551	605	4.3	150 gal.	292+TAG	20000 lb.	20000 lb.	14000 lb.	54000 lb.	74000 lb.	47200 lb.	6800 lb.
4569	605	4.3	150 gal.	292+TAG	20000 lb.	20000 lb.	14000 lb.	54000 lb.	74000 lb.	46700 lb.	7300 lb.
4595	605	4.3	150 gal.	292+TAG	20000 lb.	20000 lb.	14000 lb.	54000 lb.	74000 lb.	47300 lb.	6700 lb.

The content in our literature depicts and describes products that are subject to change. For the most recent images and information, please visit [NewmarCorp.com](https://www.NewmarCorp.com).

Lengths, heights, widths, and dry weights are approximate. Weight will vary based on optional equipment added to the above base weight.

**GAWR:** Gross Axle Weight Rating is the maximum permissible weight for an axle.

**GVWR:** Gross Vehicle Weight Rating is the maximum permissible weight for a fully loaded motor coach.

**GCWR:** Gross Combination Weight Rating is the value specified by the manufacturer of the vehicle as the maximum allowable loaded weight of this motor coach and any towed trailer or towed vehicle.

**UVW:** Unloaded Vehicle Weight is the weight of this motor coach as built at the factory with full fuel, engine oil, and coolants. Does not include cargo, fresh water, propane gas, or dealer-installed accessories.

**NCC:** Net Carrying Capacity is the maximum weight of all occupants, including the driver, personal belongings, food, fresh water, waste water, propane gas, tools, tongue weight of towed vehicle, dealer-installed accessories, etc., that can be carried by the motor coach.

**Specifications supplied by the chassis manufacturer.**

**Essex R-Values:**

- Roof R-Value = 19
- Sidewall R-Value = 11
- Floor R-Value = 16
- Basement R-Value = 4



# Features & Options



## EXTERIOR FEATURES

Full-Paint Masterpiece Finish™ with Cut and Buff and Beta Fusion Protection on Front Cap
Convex Exterior Chrome Mirrors with Remote Control, Defrost, Turn Signals and Side-View Cameras
Baggage Door Push Button, Keyless Entrance Door with Touch Pad and Door Bell
Entrance Door with Automatic Step
Rear Hitch for Towing Car
Assist Handle at Entrance Door
Dual Latched Front Entrance Door with Power Flush Stepwell Cover
Mud Flaps
Rear Protective Tow Guard with Stainless Steel Newmar Name Cutout
Undercoating
Hydraulic Leveling Jacks
Stainless Steel Exterior Trim Pieces and Entrance Door Kick Panel
Storage Bins in Pegboard Compartment
Holding Tank Levels Displayed in Exterior Water Works Compartment

OPTIONS
Stainless Steel Trim Kit for Exterior Compartment Doors
Flag Pole Bracket
Storage Tray 26 X 90 Power with Shelf in Top of Compartment, Location-Bay 2
Storage Tray 26 X 91 Non-Power with Shelf in Top of Compartment, Location-Bay 2
Storage Tray 39 X 56 Non-Power, Location-Bay 4
Storage Tray 40 X 90 Power with Shelf in Top of Compartment, Location-Bay 3
Storage Tray 42 X 91 Non-Power with Shelf in Top of Compartment, Location-Bay 3

## CONSTRUCTION FEATURES

Fiberglass Roof and Integrated Gutter Rail
Gelcoated Fiberglass Exterior Sidewalls, Front and Rear Caps
Aluminum-Frame Sidewalls and Roof Construction, 16" on Center
5/8" Foam Insulation Laminated in Sidewalls and Ceiling
Polar Pak R19 Batten Insulation on Roof
Automatic Mechanical Lock Arms on Non Hydraulic Slideout Rooms-Paddle Style
Egress Door with Ladder System

## WINDOWS, AWNINGS, & VENTS

Frameless Double-Pane Tinted Safety-Glass Windows
Fan-Tastic® Vent with Rain Sensor with Hardwood Louvered Cover in Kitchen, Bathroom and Enclosed Stool Room
Girard® Two Nova Side Awnings with Window Sensor, Remote Control and LED Lights

Girard® Slideout Covers, Entrance Door and Power Window Awnings*
Large Non-Ventilated Living Room and Dinette Windows
One-Piece Tinted Windshield
Driver Side Power Window

OPTIONS
Kitchen Window

## CHASSIS FEATURES

Air Leveling Control System
Alcoa Dura-Bright Aluminum Wheels
Automatic High Beam Headlights
Electronic Chassis Information Center in Dash
Electronic Stability Control
Cummins Connected Diagnostic System
Cruise Control
Comfort Drive™ Steering with Power Column and Adjustable Control
Recessed Fuel Fills with Crossover to Fill from Either Side
Back-Up Alarm
Blind Spot Detection
Anti-Lock Braking System
Chassis Battery Disconnect
Automatic Headlights On/Off
Push Button Engine Start
Glass Dash Instrument Panel
OnGuard™ Collision Mitigation Adaptive Cruise System with Adjustable Following Distance Control on Spartan® Chassis
Tire Pressure Displayed on Glass Dash
Memory Settings for Driver Seat Pedals, Steering Column and Mirrors
Mobileye® Displayed on Digital Dash via Xite Radio Interface on Spartan® Chassis
Mobileye® Lane Tracking and Lane Departure Warning System
Power Tilt and Telescope VIP Smart Steering Wheel
Spartan® K3, Tag Axle, 605Hp
Steering Wheel Nine Function Switch Pod in Center on Spartan® Chassis
Tank Dump Side Tilt Mode
Trailer Tow Mode
Valid Digital Glare Free Dash
Valor Generation 3 TPMS System

OPTIONS
Curt Spectrum Integrated Brake Control on Spartan® Chassis Only



## AIR CONDITIONING & HEATING

Three 15K BTU Penguin™ Heat Pump Central Air Conditioners with Remote Control Thermostat
Chinook Dual Loop Heat with Continuous Hot Water
Dash Heater and Air Conditioner
Driver and Passenger Dash Overhead Ventilation System
Roof Air Conditioning Drainage System
Electric Radiant Heat Installed Below Main Floor Tile

## ELECTRICAL FEATURES

12.5 kW Cummins Onan® Diesel Generator with Auto Changeover on Hydraulic Slideout Tray
10 Watt Solar Panel to Charge Chassis Battery
50 Amp Electrical Service with Flexible Cord with Automatic Transfer Switch
Battery Disconnect Switch for House Battery
Lithium Ion 640 AHR Battery System with Two 3000 Watt True Sine Inverters
12 Volt Auxiliary Receptacle on Dashboard
Emergency Engine Start Switch
Engine Block Heater
Exterior Security Lights
Mid-Ship Side Turn Signals
LED Lights Recessed in Ceiling and Underneath Overhead Cabinets
Accent Lights in Feature Ceiling, Lambrequins, Kitchen, Bed Base, Fascia Trim and Under Dash
Reading Lights at Head of Bed-Dimmable with Adjustable Aim
Lighted Vanity Mirrors
Manually Operated Hold-To-Run Slideout Switch
Automatic Generator Start on Low Battery or Temperature Setting
Cable TV Connection
Interior Courtesy Lights
USB Outlet at for Driver Use
110 Volt Recept in Bed Overhead with Two Pass-Through Ports
KIB Touch Screen Interior Light and Shade Controls
Power Rewind Wheel with 50' Cord*
Secondary Multiple Touch Screen in Bedroom
Silverleaf® Multiplex Electrical Wiring System
Solar Prep with Six Gauge Wire from Roof to House Battery Compartment
Spare Fuses in Chassis and House Fuse Panels
LED Lights in Exterior Storage Compartments on Automatic Switches

LED Lights Installed Below Under Door Side Slideouts
Exterior LED Accent Lights Above Rear Tow Guard
LED Docking Lights with Stainless Steel Trim
Rear Hitch Docking Light
Wireless Charging Mat Built into Passenger Console
High Power USB Charger at Dinette and Bedroom Night Stand
Wireless Charging Mat Built into Dash and Nightstand Tops
Wireless Charging Mat Built into Passenger Console
USB Outlet High Power at Dinette and Bedroom Night Stand
Transfer Switch with Surge Protector
Dash Radio, Cameras and Monitors to Power-up from Both House Batteries and Ignition

### OPTIONS

Four Flexible 110 Watt Solar Panels on Roof
30 Amp/120 Volt Cord Connection for Stacker Trailer
LED Strip Lighting Installed Under Off Door Side Slideouts
Roof Mounted Spot Light

## PLUMBING & BATH FEATURES

Demand Water System
Sewage and Grey Holding-Tank Rinse
Dometic® Concerto Electric Flush or Macerator China Bowl Stool*
Full Tiled Shower Walls and Floor
Fold-Down Shower Seat*
Assist Handle in Each Shower
Water Filter for Entire Unit
Exterior Convenience Station with Hot/Cold Water, Soap and Towel Dispenser
Auto Fill for Fresh Water Tank
Bladder Tank for Water Pump System
Power Water Hose Reel
Aqua Miser® Shower System
Hot Water Line to Generator Area*
ManaBloc Plumbing System
Dump Valves Power for Holding Tanks

### OPTIONS

RV Sanicon Turbo System
-------------------------



## INTERIOR FEATURES

Designer Feature Ceiling and Cathedral Ceiling with Added Height on Rear Bath Floor Plans\*

Tile Floor in Kitchen, Bathroom, Bedroom and Living Area

Auto Motion Power Shades and Lambrequins

Auto Motion Power Shades for Windshield and Driver/Passenger Side Windows

Trim Ring Hardwood Around Windows

Hardwood Raised Panel Interior Passage Doors

Flush Handles on Swinging Bath Doors

Maximized Shoe Storage Shelves Recessed into Rear of Wardrobe\*

Shoe Storage Pull-Out in Rear Wardrobe\*

Interior Assist Handle at Main Entry Door

Fitted Non-Quilted Bedspread with Accent Pillows

Safe Located in Bedroom Wardrobe

Wastebasket in Kitchen Base Under Sink

## CABINETS & FURNITURE

Sable Maple Hardwood Cabinets with Raised Panel Doors with Matte Finish

Concealed Hinges on Cabinet Doors

Super Polished Solid-Surface Countertop in Kitchen with Undermounted Stainless Steel Sink and Sink Covers

Super Polished Solid-Surface Countertop in Bathroom and Bedroom

Lifts on Bed Top

Passenger Seat Work Station

Pull-Out Pantry Shelves\*

Pantry Electric Door Travel Lock System

Pantry with Space for Serving Trays/Bakeware

Drawers with Dove Tail Sides with Self-Closing Full Extension Ball Bearing Guides

Soft-Close Cabinet Doors\*

Cabinet Construction Unitized with Full Overlay Doors

Villa Ultra Leather Sofa and Driver/Passenger Seats with Integrated Seatbelts

Heated Front Seats with Power-Lumbar, Recline, Footrest and Queen-Sized Passenger Seat

Driver and Passenger Cooled Air Seats

Cedar Paneling in Bedroom Wardrobe\*

Extended Rotation Concealed Hinge for Washer/Dryer Cabinet Door

Side Folding Hide-A-Bed Sofa with Memory Foam Mattress\*

R5 Radius Corner Air Mattress

Full Height Wardrobes Beside Lav\*

Molded Silverware Divider Tray

Dinette Euro Booth with Two Table leaves and Two Folding Chairs\*

## OPTIONS

Driftwood Glazed Maple Hardwood Cabinets with Raised Panel Doors with Matte or Ultra High Gloss Finish

Sedona Glazed Maple Hardwood Cabinets with Raised Panel Doors with Matte or Ultra High Gloss Finish

Pearl Glazed Maple Hardwood Cabinets with Raised Panel Doors Painted

Sable Maple Hardwood Cabinets with Raised Panel Doors with Ultra High Gloss Finish

Power Extenda Flex Dinette

U-Dinette with Power Adjustable Table

Euro Booth Dinette with Two Table Leaves and Two Folding Chairs

Combination Desk/Dinette with Buffet Table, Two Fixed/Two Folding Chairs

Two Recliners with Lampstand and Reading Lights

Driver Seat with Massage Feature

Passenger Seat Queen Size

Passenger Seat Queen Size with Massage Feature

Passenger Seat-Standard Width with Massage Feature

Overhead Cabinet Above Dinette

Overhead Cabinet in Dinette/Living Room Slideout

Powered Theater Seating 84"

Powered Theater Seating 87"

One Ottoman\*

## APPLIANCES & ACCESSORIES

Air Horns

Bosch® 21.6 Cu. Ft. Stainless Steel Refrigerator

Bosch® 30" Stainless Steel Convection Microwave

Splendide® Two-Piece Stacked Washer and Dryer

Dometic® 3.0 Cu. Ft. Freezer on Pull-Out Tray in Exterior Baggage Compartment\*

Storage Shelf Above Freezer

Central Vacuum with Tool Kit

Bosch® All Electric, Flush Mount Induction Cooktop with Three Burners

## OPTIONS

Dishwasher in Drawer with Wood Panel Front

Beverage Center with Wine Cooler and Stemware Rack



## AUDIO, VIDEO & ACCESSORIES

Samsung® LED TV in Living and Bedroom Areas\* (TV Sizes Vary Per Floor Plan)

Samsung® 50" 4K LED TV on Televator in Living Area\*

Samsung® 43" 4K LED TV in Front Overhead

Bose® 500 Subwoofer

Bose® 900 Sound Touch Soundbar in Livingroom

Bose® Bedroom Speaker

Dash Radio with Touch Screen Navigation, Dual Monitors, Harman/JBL 360 Watt Sound System and Subwoofer

Internet Connectivity for Remote Access to Motorhome

Samsung® Tablet with Control of AV Equipment, Lights, Shades, Keyless Entry and Silverleaf® App

Winegard Rayzar Automatic Digital TV Antenna

Satellite Dish Prep on Roof

Radio SiriusXM® Capability with Antenna (Does Not Include Monthly Subscription)

TV Jack and 110 Volt Recept in Door Side Exterior Storage Compartment

Cat 6 TV Cables

Infrared Repeater System to Operate Audio/Visual Components

WiFiRanger Denali/Spruce LTE

Xite HD 360 Camera System with Predictive Grid Lines and Tri-View Rear Camera

Xite Dash Radio with Apple CarPlay™, 10" Duel Monitor with Nav-N-Go Navigation System

10 Bc Fire Extinguisher, Smoke Detector, Propane and Carbon Monoxide Detector

### OPTIONS

Exterior Entertainment Center in Sidewall with Samsung® 43" 4K LED TV and Bose® Soundbar

Exterior Entertainment Center in Storage Compartment with Samsung® 43" 4K LED TV and Bose® Soundbar

Extra Monitor on Passenger Side

Security System

Universal Toll Module

Rear Camera (2) Prep for Use with Stacker Trailer

WiFi System Everest with Aspen Interior Router

Winegard Automatic Open Face Satellite Dish-for DISH HD and Bell HD TV

Winegard Automatic Open Face SWM Satellite Dish-for DIRECTV Std/HD and In-Motion DIRECTV Std, DISH Std/HD

Winegard Automatic Open Face Satellite Dish and Winegard In-Motion-for DISH Network

Winegard Automatic Open Face Satellite Dish-for DIRECTV

Winegard In-Motion Dome Satellite Dish-for DISH Std/HD, DIRECTV Std and Bell Canada





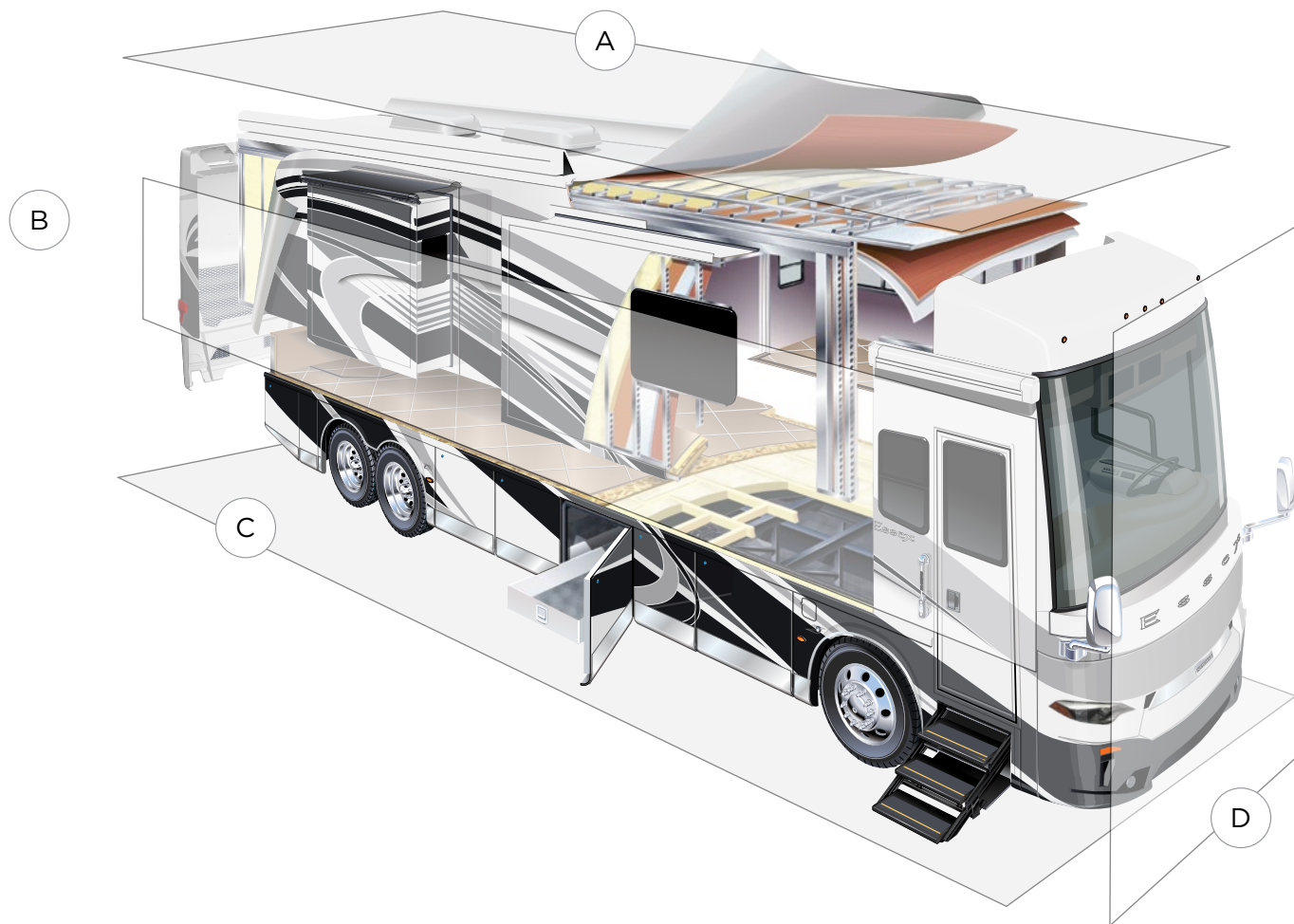

## A. ROOF

Fiberglass Roof  
Batten Insulation  
A/C Ducting  
16" on Center Aluminum Rafter Framing  
Kraft Paper Vapor Barrier  
5/8" Bead Foam  
3/16" Panel  
Padded Vinyl Overlay

## B. SIDEWALL

Interior Wall Panel  
5/8" Bead Foam  
Kraft Paper Vapor Barrier  
Batten Insulation  
Composite One-Piece  
Gelcoat Exterior Sidewall  
Aluminum Framing

## C. FLOOR

Carpet/Tile  
Carpet Padding  
5/8" Floor Decking  
Batten Insulation  
16" on Center Wood Framing  
Polyethylene Moisture Barrier

## D. EXTERIOR

15K BTU Penguin™ Heat Pump Central  
Air Conditioner  
One-Piece Bonded Windshield  
Coated Aluminum Wheels  
Frameless, Double-Pane,  
Tinted Safety Glass Windows  
Side-Hinged Baggage Doors with  
Optional Pull-Out Tray



# The Newmar Customer Experience

The Newmar Difference™ goes beyond our industry-leading motor coaches to provide you with an unrivaled ownership experience.



## Quality from the Start

Every Newmar is crafted one at a time by folks who have spent an average of eight years building them. And each coach we assemble must undergo more than 1,000 tests and checks before ever leaving our factory.



## Carefully Selected Dealers

We view our dealership network in terms of quality, not quantity. Each of our dealers acts as a partner in our shared mission to exceed your highest of expectations, for an ownership experience that's second to none from day one.



## Everything in One Place

As a Newmar owner, you'll find resources specific to your coach through Newgle, an easy-to-use knowledge base that houses everything from user guides to technical support documents.



## Friends for Life

Meet fellow owners through the Newmar Kountry Klub, a top social club for RV travelers that hosts rallies and other special events throughout the U.S. and Canada.



## Seamless Service

When you join the Newmar family, we pair you with a dedicated service specialist with expert knowledge of your exact coach. Our service specialists guarantee dealer warranty authorizations within four business hours and ship all in-stock parts the same day, free of charge.



## Rock-Solid Protection

All models include a one-year/unlimited mileage limited warranty and a five-year, non-transferable structural warranty that covers your coach's superstructure in the event it fails to perform. Ask your Newmar dealer for more details.



*Our Partners*

The Newmar Difference™ begins with suppliers dedicated to providing our customers with unrivaled quality, comfort, and support.



*BASF*

The Coatings division of BASF is a global expert in the development and production of innovative and sustainable OEM and refinish coatings. Coatings by BASF—solutions beyond your imagination.



Driven By You

*Freightliner  
Custom Chassis*

Freightliner Custom Chassis are renowned for their exceptional ride, excellent maneuverability, advanced technology, and nationwide 24/7 factory-direct support.



*Industrial Finishes*

Industrial Finishes has supported RV manufacturers for over four decades, offering paint products that deliver uncompromising quality and provide your coach with a true Masterpiece™ finish.



*RiverPark*

From Samsung® 4K TVs and Xite Infotainment systems to Bose® soundbars and JBL and Infinity premium audio systems, RiverPark helps you experience a higher level of technology in your Newmar coach.



*Spartan RV Chassis*

An American company with over 30 years of experience in designing and manufacturing the premier motorhome chassis, Spartan delivers superior performance, exceptional safety ratings, and industry-leading technology.





WHEN YOU KNOW THE DIFFERENCE<sup>SM</sup>